

Contract for the sale and purchase of land 2019 edition

TERM	MEANING OF TERM	eCOS ID: 84652781	NSW DAN:
vendor's agent	First National Real Estate David Haggarty 454 High Street MAITLAND NSW 2320		Phone: 4933 5544 Fax: 4933 1706 Ref: Jade Tweedie
co-agent			
vendor			
vendor's solicitor	RM Legal & Conveyancing 5/ 53 Elwell Close Beresfield NSW 2322 PO Box 142 Beresfield NSW 2322		Phone: 02 4018 7555 Fax: Ref: JM:2021/3028
date for completion	84 days after the contract date	(clause 15)	Email: hello@rmlc.com.au
land	2/9A WALTER ST RUTHERFORD NSW 2320		
(Address, plan details and title reference)	Registered Plan LOT 131 IN DEPOSITED PLAN 1120704 Folio Identifier 131/1120704		
improvements	<input checked="" type="checkbox"/> VACANT POSSESSION <input type="checkbox"/> Subject to existing tenancies <input checked="" type="checkbox"/> HOUSE <input checked="" type="checkbox"/> garage <input type="checkbox"/> carport <input type="checkbox"/> home unit <input type="checkbox"/> carspace <input type="checkbox"/> storage space <input type="checkbox"/> none <input type="checkbox"/> other:		
attached copies	<input checked="" type="checkbox"/> documents in the List of Documents as marked or as numbered: <input type="checkbox"/> other documents:		

A real estate agent is permitted by legislation to fill up the items in this box in a sale of residential property.

inclusions	<input checked="" type="checkbox"/> blinds <input checked="" type="checkbox"/> dishwasher <input checked="" type="checkbox"/> light fittings <input checked="" type="checkbox"/> stove <input checked="" type="checkbox"/> built-in wardrobes <input checked="" type="checkbox"/> fixed floor coverings <input checked="" type="checkbox"/> range hood <input type="checkbox"/> pool equipment <input checked="" type="checkbox"/> clothes line <input checked="" type="checkbox"/> insect screens <input type="checkbox"/> solar panels <input checked="" type="checkbox"/> TV antenna <input checked="" type="checkbox"/> curtains <input checked="" type="checkbox"/> other: ceiling fans, air conditioner, auto garage door opener
exclusions	Shelving in the garage
purchaser	
purchaser's solicitor	Phone: Fax: Ref: Email:
price	\$
deposit	\$ (10% of the price, unless otherwise stated)
balance	\$
contract date	(if not stated, the date this contract was made)

buyer's agent

vendor		witness
<div style="border: 1px solid black; padding: 5px; width: fit-content; margin: 0 auto;"> GST AMOUNT (optional) The price includes GST of: \$ </div>		

purchaser JOINT TENANTS tenants in common in unequal shares witness

vendor agrees to accept a *deposit-bond* (clause 3) NO yes

Nominated *Electronic Lodgment Network (ELN)* (clause 30) PEXA

Electronic transaction (clause 30) no YES

(if no, vendor must provide further details, such as the proposed applicable waiver, in the space below, or *serve within 14 days* of the contract date):

Tax information (the parties promise this is correct as far as each party is aware)

land tax is adjustable NO yes

GST: Taxable supply NO yes in full yes to an extent

Margin scheme will be used in making the taxable supply NO yes

This sale is not a taxable supply because (one or more of the following may apply) the sale is:

- not made in the course or furtherance of an enterprise that the vendor carries on (section 9-5(b))
- by a vendor who is neither registered nor required to be registered for GST (section 9-5(d))
- GST-free because the sale is the supply of a going concern under section 38-325
- GST-free because the sale is subdivided farm land or farm land supplied for farming under Subdivision 38-O
- input taxed because the sale is of eligible residential premises (sections 40-65, 40-75(2) and 195-1)

Purchaser must make an *GSTRW payment* (residential withholding payment) NO yes (if yes, vendor must provide further details)

If the further details below are not fully completed at the contract date, the vendor must provide all these details in a separate notice *within 14 days* of the contract date.

GSTRW payment (GST residential withholding payment) – further details

Frequently the supplier will be the vendor. However, sometimes further information will be required as to which entity is liable for GST, for example, if the supplier is a partnership, a trust, part of a GST group or a participant in a GST joint venture.

Supplier's name:

Supplier's ABN:

Supplier's GST branch number (if applicable):

Supplier's business address:

Supplier's email address:

Supplier's phone number:

Supplier's proportion of *GSTRW payment*: \$

If more than one supplier, provide the above details for each supplier.

Amount purchaser must pay – price multiplied by the *RW rate* (residential withholding rate): \$

Amount must be paid: AT COMPLETION at another time (specify):

Is any of the consideration not expressed as an amount in money? NO yes

If "yes", the GST inclusive market value of the non-monetary consideration: \$

Other details (including those required by regulation or the ATO forms):

List of Documents

General	Strata or community title (clause 23 of the contract)
<input checked="" type="checkbox"/> 1 property certificate for the land	<input type="checkbox"/> 32 property certificate for strata common property
<input checked="" type="checkbox"/> 2 plan of the land	<input type="checkbox"/> 33 plan creating strata common property
<input type="checkbox"/> 3 unregistered plan of the land	<input type="checkbox"/> 34 strata by-laws
<input type="checkbox"/> 4 plan of land to be subdivided	<input type="checkbox"/> 35 strata development contract or statement
<input type="checkbox"/> 5 document that is to be lodged with a relevant plan	<input type="checkbox"/> 36 strata management statement
<input checked="" type="checkbox"/> 6 section 10.7(2) planning certificate under Environmental Planning and Assessment Act 1979	<input type="checkbox"/> 37 strata renewal proposal
<input type="checkbox"/> 7 additional information included in that certificate under section 10.7(5)	<input type="checkbox"/> 38 strata renewal plan
<input type="checkbox"/> 8 sewerage infrastructure location diagram (service location diagram)	<input type="checkbox"/> 39 leasehold strata - lease of lot and common property
<input checked="" type="checkbox"/> 9 sewer lines location diagram (sewerage service diagram)	<input type="checkbox"/> 40 property certificate for neighbourhood property
<input type="checkbox"/> 10 document that created or may have created an easement, profit à prendre, restriction on use or positive covenant disclosed in this contract	<input type="checkbox"/> 41 plan creating neighbourhood property
<input type="checkbox"/> 11 <i>planning agreement</i>	<input type="checkbox"/> 42 neighbourhood development contract
<input type="checkbox"/> 12 section 88G certificate (positive covenant)	<input type="checkbox"/> 43 neighbourhood management statement
<input type="checkbox"/> 13 survey report	<input type="checkbox"/> 44 property certificate for precinct property
<input type="checkbox"/> 14 building information certificate or building certificate given under <i>legislation</i>	<input type="checkbox"/> 45 plan creating precinct property
<input type="checkbox"/> 15 lease (with every relevant memorandum or variation)	<input type="checkbox"/> 46 precinct development contract
<input type="checkbox"/> 16 other document relevant to tenancies	<input type="checkbox"/> 47 precinct management statement
<input type="checkbox"/> 17 licence benefiting the land	<input type="checkbox"/> 48 property certificate for community property
<input type="checkbox"/> 18 old system document	<input type="checkbox"/> 49 plan creating community property
<input type="checkbox"/> 19 Crown purchase statement of account	<input type="checkbox"/> 50 community development contract
<input type="checkbox"/> 20 building management statement	<input type="checkbox"/> 51 community management statement
<input checked="" type="checkbox"/> 21 form of requisitions	<input type="checkbox"/> 52 document disclosing a change of by-laws
<input type="checkbox"/> 22 <i>clearance certificate</i>	<input type="checkbox"/> 53 document disclosing a change in a development or management contract or statement
<input type="checkbox"/> 23 land tax certificate	<input type="checkbox"/> 54 document disclosing a change in boundaries
Home Building Act 1989	<input type="checkbox"/> 55 information certificate under Strata Schemes Management Act 2015
<input type="checkbox"/> 24 insurance certificate	<input type="checkbox"/> 56 information certificate under Community Land Management Act 1989
<input type="checkbox"/> 25 brochure or warning	<input type="checkbox"/> 57 disclosure statement - off the plan contract
<input type="checkbox"/> 26 evidence of alternative indemnity cover	<input type="checkbox"/> 58 other document relevant to off the plan contract
Swimming Pools Act 1992	Other
<input type="checkbox"/> 27 certificate of compliance	<input type="checkbox"/> 59
<input type="checkbox"/> 28 evidence of registration	
<input type="checkbox"/> 29 relevant occupation certificate	
<input type="checkbox"/> 30 certificate of non-compliance	
<input type="checkbox"/> 31 detailed reasons of non-compliance	

HOLDER OF STRATA OR COMMUNITY TITLE RECORDS – Name, address, email address and telephone number

IMPORTANT NOTICE TO VENDORS AND PURCHASERS

Before signing this contract you should ensure that you understand your rights and obligations, some of which are not written in this contract but are implied by law.

WARNING—SMOKE ALARMS

The owners of certain types of buildings and strata lots must have smoke alarms (or in certain cases heat alarms) installed in the building or lot in accordance with regulations under the *Environmental Planning and Assessment Act 1979*. It is an offence not to comply. It is also an offence to remove or interfere with a smoke alarm or heat alarm. Penalties apply.

WARNING—LOOSE-FILL ASBESTOS INSULATION

Before purchasing land that includes any residential premises (within the meaning of Division 1A of Part 8 of the *Home Building Act 1989*) built before 1985, a purchaser is strongly advised to consider the possibility that the premises may contain loose-fill asbestos insulation (within the meaning of Division 1A of Part 8 of the *Home Building Act 1989*). In particular, a purchaser should:

- (a) search the Register required to be maintained under Division 1A of Part 8 of the *Home Building Act 1989*, and
- (b) ask the relevant local council whether it holds any records showing that the residential premises contain loose-fill asbestos insulation.

For further information about loose-fill asbestos insulation (including areas in which residential premises have been identified as containing loose-fill asbestos insulation), contact NSW Fair Trading.

COOLING OFF PERIOD (PURCHASER'S RIGHTS)

1. This is the statement required by section 66X of the *Conveyancing Act 1919* and applies to a contract for the sale of residential property.
2. **EXCEPT** in the circumstances listed in paragraph 3, the purchaser may rescind the contract at any time before 5 pm on—
 - (a) the tenth business day after the day on which the contract was made—in the case of an off the plan contract, or
 - (b) the fifth business day after the day on which the contract was made—in any other case.
3. There is **NO COOLING OFF PERIOD**:
 - (a) if, at or before the time the contract is made, the purchaser gives to the vendor (or the vendor's solicitor or agent) a certificate that complies with section 66W of the Act, or
 - (b) if the property is sold by public auction, or
 - (c) if the contract is made on the same day as the property was offered for sale by public auction but passed in, or
 - (d) if the contract is made in consequence of the exercise of an option to purchase the property, other than an option that is void under section 66ZG of the Act.
4. A purchaser exercising the right to cool off by rescinding the contract will forfeit to the vendor 0.25% of the purchase price of the property. The vendor is entitled to recover the amount forfeited from any amount paid by the purchaser as a deposit under the contract and the purchaser is entitled to a refund of any balance.

DISPUTES

If you get into a dispute with the other party, the Law Society and Real Estate Institute encourage you to use informal procedures such as negotiation, independent expert appraisal, the Law Society Conveyancing Dispute Resolution Scheme or mediation (for example mediation under the Law Society Mediation Program).

AUCTIONS

Regulations made under the Property, Stock and Business Agents Act 2002 prescribe a number of conditions applying to sales by auction.

WARNINGS

1. Various Acts of Parliament and other matters can affect the rights of the parties to this contract. Some important matters are actions, claims, decisions, licences, notices, orders, proposals or rights of way involving:

<p>APA Group Australian Taxation Office Council County Council Department of Planning, Industry and Environment Department of Primary Industries Electricity and gas Land & Housing Corporation Local Land Services</p>	<p>NSW Department of Education NSW Fair Trading Owner of adjoining land Privacy Public Works Advisory Subsidence Advisory NSW Telecommunications Transport for NSW Water, sewerage or drainage authority</p>
---	--

If you think that any of these matters affects the property, tell your solicitor.
2. A lease may be affected by the Agricultural Tenancies Act 1990, the Residential Tenancies Act 2010 or the Retail Leases Act 1994.
3. If any purchase money is owing to the Crown, it will become payable before obtaining consent, or if no consent is needed, when the transfer is registered.
4. If a consent to transfer is required under legislation, see clause 27 as to the obligations of the parties.
5. The vendor should continue the vendor's insurance until completion. If the vendor wants to give the purchaser possession before completion, the vendor should first ask the insurer to confirm this will not affect the insurance.
6. The purchaser will usually have to pay transfer duty (and sometimes surcharge purchaser duty) on this contract. If duty is not paid on time, a purchaser may incur penalties.
7. If the purchaser agrees to the release of deposit, the purchaser's right to recover the deposit may stand behind the rights of others (for example the vendor's mortgagee).
8. The purchaser should arrange insurance as appropriate.
9. Some transactions involving personal property may be affected by the Personal Property Securities Act 2009.
10. A purchaser should be satisfied that finance will be available at the time of completing the purchase.
11. Where the market value of the property is at or above a legislated amount, the purchaser may have to comply with a foreign resident capital gains withholding payment obligation (even if the vendor is not a foreign resident). If so, this will affect the amount available to the vendor on completion.
12. Purchasers of some residential properties may have to withhold part of the purchase price to be credited towards the GST liability of the vendor. If so, this will also affect the amount available to the vendor. More information is available from the ATO.

The vendor sells and the purchaser buys the *property* for the price under these provisions instead of Schedule 3 Conveyancing Act 1919, subject to any *legislation* that cannot be excluded.

1 Definitions (a term in italics is a defined term)

In this contract, these terms (in any form) mean –

<i>adjustment date</i>	the earlier of the giving of possession to the purchaser or completion;
<i>bank</i>	the Reserve Bank of Australia or an authorised deposit-taking institution which is a bank, a building society or a credit union;
<i>business day</i>	any day except a bank or public holiday throughout NSW, or a Saturday or Sunday;
<i>cheque</i>	a cheque that is not postdated or stale;
<i>clearance certificate</i>	a certificate within the meaning of s14-220 of Schedule 1 to the <i>TA Act</i> , that covers one or more days falling within the period from and including the contract date to completion;
<i>deposit-bond</i>	a deposit bond or guarantee from an issuer, with an expiry date and for an amount each approved by the vendor;
<i>depositholder</i>	vendor's agent (or if no vendor's agent is named in this contract, the vendor's <i>solicitor</i> , or if no vendor's <i>solicitor</i> is named in this contract, the buyer's agent);
<i>document of title</i>	document relevant to the title or the passing of title;
<i>FRCGW percentage</i>	the percentage mentioned in s14-200(3)(a) of Schedule 1 to the <i>TA Act</i> (12.5% as at 1 July 2017);
<i>FRCGW remittance</i>	a remittance which the purchaser must make under s14-200 of Schedule 1 to the <i>TA Act</i> , being the lesser of the <i>FRCGW percentage</i> of the price (inclusive of GST, if any) and the amount specified in a <i>variation served by a party</i> ;
<i>GST Act</i>	A New Tax System (Goods and Services Tax) Act 1999;
<i>GST rate</i>	the rate mentioned in s4 of A New Tax System (Goods and Services Tax Imposition - General) Act 1999 (10% as at 1 July 2000);
<i>GSTRW payment</i>	a payment which the purchaser must make under s14-250 of Schedule 1 to the <i>TA Act</i> (the price multiplied by the <i>GSTRW rate</i>);
<i>GSTRW rate</i>	the rate determined under ss14-250(6), (8) or (9) of Schedule 1 to the <i>TA Act</i> (as at 1 July 2018, usually 7% of the price if the margin scheme applies, 1/11 th if not);
<i>legislation</i>	an Act or a by-law, ordinance, regulation or rule made under an Act;
<i>normally</i>	subject to any other provision of this contract;
<i>party</i>	each of the vendor and the purchaser;
<i>property</i>	the land, the improvements, all fixtures and the inclusions, but not the exclusions;
<i>planning agreement</i>	a valid voluntary agreement within the meaning of s7.4 of the Environmental Planning and Assessment Act 1979 entered into in relation to the <i>property</i> ;
<i>requisition</i>	an objection, question or requisition (but the term does not include a claim);
<i>rescind</i>	rescind this contract from the beginning;
<i>serve</i>	serve in writing on the other <i>party</i> ;
<i>settlement cheque</i>	an unendorsed <i>cheque</i> made payable to the person to be paid and – <ul style="list-style-type: none"> • issued by a <i>bank</i> and drawn on itself; or • if authorised in writing by the vendor or the vendor's <i>solicitor</i>, some other <i>cheque</i>;
<i>solicitor</i>	in relation to a <i>party</i> , the <i>party's</i> solicitor or licensed conveyancer named in this contract or in a notice <i>served</i> by the <i>party</i> ;
<i>TA Act</i>	Taxation Administration Act 1953;
<i>terminate</i>	terminate this contract for breach;
<i>variation</i>	a variation made under s14-235 of Schedule 1 to the <i>TA Act</i> ;
<i>within</i>	in relation to a period, at any time before or during the period; and
<i>work order</i>	a valid direction, notice or order that requires work to be done or money to be spent on or in relation to the <i>property</i> or any adjoining footpath or road (but the term does not include a notice under s22E of the Swimming Pools Act 1992 or clause 22 of the Swimming Pools Regulation 2018).

2 Deposit and other payments before completion

- 2.1 The purchaser must pay the deposit to the *depositholder* as stakeholder.
- 2.2 *Normally*, the purchaser must pay the deposit on the making of this contract, and this time is essential.
- 2.3 If this contract requires the purchaser to pay any of the deposit by a later time, that time is also essential.
- 2.4 The purchaser can pay any of the deposit by giving cash (up to \$2,000) or by unconditionally giving a *cheque* to the *depositholder* or to the vendor, vendor's agent or vendor's *solicitor* for sending to the *depositholder* or by payment by electronic funds transfer to the *depositholder*.
- 2.5 If any of the deposit is not paid on time or a *cheque* for any of the deposit is not honoured on presentation, the vendor can *terminate*. This right to *terminate* is lost as soon as the deposit is paid in full.
- 2.6 If the vendor accepts a bond or guarantee for the deposit, clauses 2.1 to 2.5 do not apply.

BREACH OF COPYRIGHT MAY RESULT IN LEGAL ACTION

- 2.7 If the vendor accepts a bond or guarantee for part of the deposit, clauses 2.1 to 2.5 apply only to the balance.
- 2.8 If any of the deposit or of the balance of the price is paid before completion to the vendor or as the vendor directs, it is a charge on the land in favour of the purchaser until *termination* by the vendor or completion, subject to any existing right.
- 2.9 If each *party* tells the *depositholder* that the deposit is to be invested, the *depositholder* is to invest the deposit (at the risk of the *party* who becomes entitled to it) with a *bank*, in an interest-bearing account in NSW, payable at call, with interest to be reinvested, and pay the interest to the *parties* equally, after deduction of all proper government taxes and financial institution charges and other charges.

3 Deposit-bond

- 3.1 This clause applies only if this contract says the vendor has agreed to accept a *deposit-bond* for the deposit (or part of it).
- 3.2 The purchaser must provide the original *deposit-bond* to the vendor's *solicitor* (or if no *solicitor* the *depositholder*) at or before the making of this contract and this time is essential.
- 3.3 If the *deposit-bond* has an expiry date and completion does not occur by the date which is 14 days before the expiry date, the purchaser must serve a replacement *deposit-bond* at least 7 days before the expiry date. The time for service is essential.
- 3.4 The vendor must approve a replacement *deposit-bond* if –
- 3.4.1 it is from the same issuer and for the same amount as the earlier *deposit-bond*; and
- 3.4.2 it has an expiry date at least three months after its date of issue.
- 3.5 A breach of clauses 3.2 or 3.3 entitles the vendor to *terminate*. The right to *terminate* is lost as soon as –
- 3.5.1 the purchaser serves a replacement *deposit-bond*; or
- 3.5.2 the deposit is paid in full under clause 2.
- 3.6 Clauses 3.3 and 3.4 can operate more than once.
- 3.7 If the purchaser serves a replacement *deposit-bond*, the vendor must serve the earlier *deposit-bond*.
- 3.8 The amount of any *deposit-bond* does not form part of the price for the purposes of clause 16.7.
- 3.9 The vendor must give the purchaser the *deposit-bond* –
- 3.9.1 on completion; or
- 3.9.2 if this contract is *rescinded*.
- 3.10 If this contract is *terminated* by the vendor –
- 3.10.1 normally, the vendor can immediately demand payment from the issuer of the *deposit-bond*; or
- 3.10.2 if the purchaser serves prior to *termination* a notice disputing the vendor's right to *terminate*, the vendor must forward the *deposit-bond* (or its proceeds if called up) to the *depositholder* as stakeholder.
- 3.11 If this contract is *terminated* by the purchaser –
- 3.11.1 normally, the vendor must give the purchaser the *deposit-bond*; or
- 3.11.2 if the vendor serves prior to *termination* a notice disputing the purchaser's right to *terminate*, the vendor must forward the *deposit-bond* (or its proceeds if called up) to the *depositholder* as stakeholder.

4 Transfer

- 4.1 Normally, the purchaser must serve at least 14 days before the date for completion –
- 4.1.1 the form of transfer; and
- 4.1.2 particulars required to register any mortgage or other dealing to be lodged with the transfer by the purchaser or the purchaser's mortgagee.
- 4.2 If any information needed for the form of transfer is not disclosed in this contract, the vendor must serve it.
- 4.3 If the purchaser serves a form of transfer and the transferee is not the purchaser, the purchaser must give the vendor a direction signed by the purchaser personally for this form of transfer.
- 4.4 The vendor can require the purchaser to include a form of covenant or easement in the transfer only if this contract contains the wording of the proposed covenant or easement, and a description of the land benefited.

5 Requisitions

- 5.1 If a form of *requisitions* is attached to this contract, the purchaser is taken to have made those *requisitions*.
- 5.2 If the purchaser is or becomes entitled to make any other *requisition*, the purchaser can make it only by serving it –
- 5.2.1 if it arises out of this contract or it is a general question about the *property* or title - within 21 days after the contract date;
- 5.2.2 if it arises out of anything served by the vendor - within 21 days after the later of the contract date and that service; and
- 5.2.3 in any other case - within a reasonable time.

6 Error or misdescription

- 6.1 Normally, the purchaser can (but only before completion) claim compensation for an error or misdescription in this contract (as to the *property*, the title or anything else and whether substantial or not).
- 6.2 This clause applies even if the purchaser did not take notice of or rely on anything in this contract containing or giving rise to the error or misdescription.
- 6.3 However, this clause does not apply to the extent the purchaser knows the true position.

7 Claims by purchaser

Normally, the purchaser can make a claim (including a claim under clause 6) before completion only by *servicing* it with a statement of the amount claimed, and if the purchaser makes one or more claims before completion –

- 7.1 the vendor can *rescind* if in the case of claims that are not claims for delay –
- 7.1.1 the total amount claimed exceeds 5% of the price;
 - 7.1.2 the vendor *serves* notice of intention to *rescind*; and
 - 7.1.3 the purchaser does not *serve* notice waiving the claims *within* 14 days after that *service*; and
- 7.2 if the vendor does not *rescind*, the *parties* must complete and if this contract is completed –
- 7.2.1 the lesser of the total amount claimed and 10% of the price must be paid out of the price to and held by the *depositholder* until the claims are finalised or lapse;
 - 7.2.2 the amount held is to be invested in accordance with clause 2.9;
 - 7.2.3 the claims must be finalised by an arbitrator appointed by the *parties* or, if an appointment is not made *within* 1 month of completion, by an arbitrator appointed by the President of the Law Society at the request of a *party* (in the latter case the *parties* are bound by the terms of the Conveyancing Arbitration Rules approved by the Law Society as at the date of the appointment);
 - 7.2.4 the purchaser is not entitled, in respect of the claims, to more than the total amount claimed and the costs of the purchaser;
 - 7.2.5 net interest on the amount held must be paid to the *parties* in the same proportion as the amount held is paid; and
 - 7.2.6 if the *parties* do not appoint an arbitrator and neither *party* requests the President to appoint an arbitrator *within* 3 months after completion, the claims lapse and the amount belongs to the vendor.

8 Vendor's rights and obligations

- 8.1 The vendor can *rescind* if –
- 8.1.1 the vendor is, on reasonable grounds, unable or unwilling to comply with a *requisition*;
 - 8.1.2 the vendor *serves* a notice of intention to *rescind* that specifies the *requisition* and those grounds; and
 - 8.1.3 the purchaser does not *serve* a notice waiving the *requisition within* 14 days after that *service*.
- 8.2 If the vendor does not comply with this contract (or a notice under or relating to it) in an essential respect, the purchaser can *terminate* by *servicing* a notice. After the *termination* –
- 8.2.1 the purchaser can recover the deposit and any other money paid by the purchaser under this contract;
 - 8.2.2 the purchaser can sue the vendor to recover damages for breach of contract; and
 - 8.2.3 if the purchaser has been in possession a *party* can claim for a reasonable adjustment.

9 Purchaser's default

If the purchaser does not comply with this contract (or a notice under or relating to it) in an essential respect, the vendor can *terminate* by *servicing* a notice. After the *termination* the vendor can –

- 9.1 keep or recover the deposit (to a maximum of 10% of the price);
- 9.2 hold any other money paid by the purchaser under this contract as security for anything recoverable under this clause –
 - 9.2.1 for 12 months after the *termination*; or
 - 9.2.2 if the vendor commences proceedings under this clause *within* 12 months, until those proceedings are concluded; and
- 9.3 sue the purchaser either –
 - 9.3.1 where the vendor has resold the *property* under a contract made *within* 12 months after the *termination*, to recover –
 - the deficiency on resale (with credit for any of the deposit kept or recovered and after allowance for any capital gains tax or goods and services tax payable on anything recovered under this clause); and
 - the reasonable costs and expenses arising out of the purchaser's non-compliance with this contract or the notice and of resale and any attempted resale; or
 - 9.3.2 to recover damages for breach of contract.

10 Restrictions on rights of purchaser

- 10.1 The purchaser cannot make a claim or *requisition* or *rescind* or *terminate* in respect of –
- 10.1.1 the ownership or location of any fence as defined in the Dividing Fences Act 1991;
 - 10.1.2 a service for the *property* being a joint service or passing through another property, or any service for another property passing through the *property* ('service' includes air, communication, drainage, electricity, garbage, gas, oil, radio, sewerage, telephone, television or water service);
 - 10.1.3 a wall being or not being a party wall in any sense of that term or the *property* being affected by an easement for support or not having the benefit of an easement for support;
 - 10.1.4 any change in the *property* due to fair wear and tear before completion;
 - 10.1.5 a promise, representation or statement about this contract, the *property* or the title, not set out or referred to in this contract;
 - 10.1.6 a condition, exception, reservation or restriction in a Crown grant;

- 10.1.7 the existence of any authority or licence to explore or prospect for gas, minerals or petroleum;
- 10.1.8 any easement or restriction on use the substance of either of which is disclosed in this contract or any non-compliance with the easement or restriction on use; or
- 10.1.9 anything the substance of which is disclosed in this contract (except a caveat, charge, mortgage, priority notice or writ).
- 10.2 The purchaser cannot *rescind* or *terminate* only because of a defect in title to or quality of the inclusions.
- 10.3 *Normally*, the purchaser cannot make a claim or *requisition* or *rescind* or *terminate* or require the vendor to change the nature of the title disclosed in this contract (for example, to remove a caution evidencing qualified title, or to lodge a plan of survey as regards limited title).
- 11 Compliance with work orders**
- 11.1 *Normally*, the vendor must by completion comply with a *work order* made on or before the contract date and if this contract is completed the purchaser must comply with any other *work order*.
- 11.2 If the purchaser complies with a *work order*, and this contract is *rescinded* or *terminated*, the vendor must pay the expense of compliance to the purchaser.
- 12 Certificates and inspections**
- The vendor must do everything reasonable to enable the purchaser, subject to the rights of any tenant –
- 12.1 to have the *property* inspected to obtain any certificate or report reasonably required;
- 12.2 to apply (if necessary in the name of the vendor) for –
- 12.2.1 any certificate that can be given in respect of the *property* under *legislation*; or
- 12.2.2 a copy of any approval, certificate, consent, direction, notice or order in respect of the *property* given under *legislation*, even if given after the contract date; and
- 12.3 to make 1 inspection of the *property* in the 3 days before a time appointed for completion.
- 13 Goods and services tax (GST)**
- 13.1 Terms used in this clause which are not defined elsewhere in this contract and have a defined meaning in the *GST Act* have the same meaning in this clause.
- 13.2 *Normally*, if a *party* must pay the price or any other amount to the other *party* under this contract, GST is not to be added to the price or amount.
- 13.3 If under this contract a *party* must make an adjustment or payment for an expense of another party or pay an expense payable by or to a third party (for example under clauses 14 or 20.7) –
- 13.3.1 the *party* must adjust or pay on completion any GST added to or included in the expense; but
- 13.3.2 the amount of the expense must be reduced to the extent the party receiving the adjustment or payment (or the representative member of a GST group of which that party is a member) is entitled to an input tax credit for the expense; and
- 13.3.3 if the adjustment or payment under this contract is consideration for a taxable supply, an amount for GST must be added at the *GST rate*.
- 13.4 If this contract says this sale is the supply of a going concern –
- 13.4.1 the *parties* agree the supply of the *property* is a supply of a going concern;
- 13.4.2 the vendor must, between the contract date and completion, carry on the enterprise conducted on the land in a proper and business-like way;
- 13.4.3 if the purchaser is not registered by the date for completion, the *parties* must complete and the purchaser must pay on completion, in addition to the price, an amount being the price multiplied by the *GST rate* ("the retention sum"). The retention sum is to be held by the *depositholder* and dealt with as follows –
- if *within* 3 months of completion the purchaser serves a letter from the Australian Taxation Office stating the purchaser is registered with a date of effect of registration on or before completion, the *depositholder* is to pay the retention sum to the purchaser; but
 - if the purchaser does not serve that letter *within* 3 months of completion, the *depositholder* is to pay the retention sum to the vendor; and
- 13.4.4 if the vendor, despite clause 13.4.1, serves a letter from the Australian Taxation Office stating the vendor has to pay GST on the supply, the purchaser must pay to the vendor on demand the amount of GST assessed.
- 13.5 *Normally*, the vendor promises the margin scheme will not apply to the supply of the *property*.
- 13.6 If this contract says the margin scheme is to apply in making the taxable supply, the *parties* agree that the margin scheme is to apply to the sale of the *property*.
- 13.7 If this contract says the sale is not a taxable supply –
- 13.7.1 the purchaser promises that the *property* will not be used and represents that the purchaser does not intend the *property* (or any part of the *property*) to be used in a way that could make the sale a taxable supply to any extent; and
- 13.7.2 the purchaser must pay the vendor on completion in addition to the price an amount calculated by multiplying the price by the *GST rate* if this sale is a taxable supply to any extent because of –
- a breach of clause 13.7.1; or
 - something else known to the purchaser but not the vendor.
- 13.8 If this contract says this sale is a taxable supply in full and does not say the margin scheme applies to the *property*, the vendor must pay the purchaser on completion an amount of one-eleventh of the price if –

- 13.8.1 this sale is not a taxable supply in full; or
- 13.8.2 the margin scheme applies to the *property* (or any part of the *property*).
- 13.9 If this contract says this sale is a taxable supply to an extent –
- 13.9.1 clause 13.7.1 does not apply to any part of the *property* which is identified as being a taxable supply; and
- 13.9.2 the payments mentioned in clauses 13.7 and 13.8 are to be recalculated by multiplying the relevant payment by the proportion of the price which represents the value of that part of the *property* to which the clause applies (the proportion to be expressed as a number between 0 and 1). Any evidence of value must be obtained at the expense of the vendor.
- 13.10 *Normally*, on completion the vendor must give the recipient of the supply a tax invoice for any taxable supply by the vendor by or under this contract.
- 13.11 The vendor does not have to give the purchaser a tax invoice if the margin scheme applies to a taxable supply.
- 13.12 If the vendor is liable for GST on rents or profits due to issuing an invoice or receiving consideration before completion, any adjustment of those amounts must exclude an amount equal to the vendor's GST liability.
- 13.13 If the purchaser must make a *GSTRW payment* the purchaser must –
- 13.13.1 at least 5 days before the date for completion, serve evidence of submission of a *GSTRW payment* notification form to the Australian Taxation Office by the purchaser or, if a direction under clause 4.3 has been served, by the transferee named in the transfer served with that direction;
- 13.13.2 produce on completion a *settlement cheque* for the *GSTRW payment* payable to the Deputy Commissioner of Taxation;
- 13.13.3 forward the *settlement cheque* to the payee immediately after completion; and
- 13.13.4 serve evidence of receipt of payment of the *GSTRW payment* and a copy of the settlement date confirmation form submitted to the Australian Taxation Office.
- 14 Adjustments**
- 14.1 *Normally*, the vendor is entitled to the rents and profits and will be liable for all rates, water, sewerage and drainage service and usage charges, land tax, levies and all other periodic outgoings up to and including the *adjustment date* after which the purchaser will be entitled and liable.
- 14.2 The *parties* must make any necessary adjustment on completion.
- 14.3 If an amount that is adjustable under this contract has been reduced under *legislation*, the *parties* must on completion adjust the reduced amount.
- 14.4 The *parties* must not adjust surcharge land tax (as defined in the Land Tax Act 1956) but must adjust any other land tax for the year current at the *adjustment date* –
- 14.4.1 only if land tax has been paid or is payable for the year (whether by the vendor or by a predecessor in title) and this contract says that land tax is adjustable;
- 14.4.2 by adjusting the amount that would have been payable if at the start of the year –
- the person who owned the land owned no other land;
 - the land was not subject to a special trust or owned by a non-concessional company; and
 - if the land (or part of it) had no separate taxable value, by calculating its separate taxable value on a proportional area basis.
- 14.5 If any other amount that is adjustable under this contract relates partly to the land and partly to other land, the *parties* must adjust it on a proportional area basis.
- 14.6 *Normally*, the vendor can direct the purchaser to produce a *settlement cheque* on completion to pay an amount adjustable under this contract and if so –
- 14.6.1 the amount is to be treated as if it were paid; and
- 14.6.2 the *cheque* must be forwarded to the payee immediately after completion (by the purchaser if the *cheque* relates only to the *property* or by the vendor in any other case).
- 14.7 If on completion the last bill for a water, sewerage or drainage usage charge is for a period ending before the *adjustment date*, the vendor is liable for an amount calculated by dividing the bill by the number of days in the period then multiplying by the number of unbilled days up to and including the *adjustment date*.
- 14.8 The vendor is liable for any amount recoverable for work started on or before the contract date on the *property* or any adjoining footpath or road.
- 15 Date for completion**
- The *parties* must complete by the date for completion and, if they do not, a *party* can serve a notice to complete if that *party* is otherwise entitled to do so.
- 16 Completion**
- **Vendor**
- 16.1 On completion the vendor must give the purchaser any *document of title* that relates only to the *property*.
- 16.2 If on completion the vendor has possession or control of a *document of title* that relates also to other property, the vendor must produce it as and where necessary.
- 16.3 *Normally*, on completion the vendor must cause the legal title to the *property* (being an estate in fee simple) to pass to the purchaser free of any mortgage or other interest, subject to any necessary registration.
- 16.4 The legal title to the *property* does not pass before completion.

- 16.5 If the vendor gives the purchaser a document (other than the transfer) that needs to be lodged for registration, the vendor must pay the lodgment fee to the purchaser.
- 16.6 If a *party serves* a land tax certificate showing a charge on any of the land, by completion the vendor must do all things and pay all money required so that the charge is no longer effective against the land.
- **Purchaser**
- 16.7 On completion the purchaser must pay to the vendor, by cash (up to \$2,000) or *settlement cheque* –
- 16.7.1 the price less any:
- deposit paid;
 - *FRCGW remittance* payable;
 - *GSTRW payment*; and
 - amount payable by the vendor to the purchaser under this contract; and
- 16.7.2 any other amount payable by the purchaser under this contract.
- 16.8 If the vendor requires more than 5 *settlement cheques*, the vendor must pay \$10 for each extra *cheque*.
- 16.9 If any of the deposit is not covered by a bond or guarantee, on completion the purchaser must give the vendor an order signed by the purchaser authorising the *depositholder* to account to the vendor for the deposit.
- 16.10 On completion the deposit belongs to the vendor.
- **Place for completion**
- 16.11 *Normally*, the *parties* must complete at the completion address, which is –
- 16.11.1 if a special completion address is stated in this contract - that address; or
- 16.11.2 if none is stated, but a first mortgagee is disclosed in this contract and the mortgagee would usually discharge the mortgage at a particular place - that place; or
- 16.11.3 in any other case - the vendor's *solicitor's* address stated in this contract.
- 16.12 The vendor by reasonable notice can require completion at another place, if it is in NSW, but the vendor must pay the purchaser's additional expenses, including any agency or mortgagee fee.
- 16.13 If the purchaser requests completion at a place that is not the completion address, and the vendor agrees, the purchaser must pay the vendor's additional expenses, including any agency or mortgagee fee.
- 17 Possession**
- 17.1 *Normally*, the vendor must give the purchaser vacant possession of the *property* on completion.
- 17.2 The vendor does not have to give vacant possession if –
- 17.2.1 this contract says that the sale is subject to existing tenancies; and
- 17.2.2 the contract discloses the provisions of the tenancy (for example, by attaching a copy of the lease and any relevant memorandum or variation).
- 17.3 *Normally*, the purchaser can claim compensation (before or after completion) or *rescind* if any of the land is affected by a protected tenancy (a tenancy affected by Schedule 2, Part 7 of the Residential Tenancies Act 2010).
- 18 Possession before completion**
- 18.1 This clause applies only if the vendor gives the purchaser possession of the *property* before completion.
- 18.2 The purchaser must not before completion –
- 18.2.1 let or part with possession of any of the *property*;
- 18.2.2 make any change or structural alteration or addition to the *property*; or
- 18.2.3 contravene any agreement between the *parties* or any direction, document, *legislation*, notice or order affecting the *property*.
- 18.3 The purchaser must until completion –
- 18.3.1 keep the *property* in good condition and repair having regard to its condition at the giving of possession; and
- 18.3.2 allow the vendor or the vendor's authorised representative to enter and inspect it at all reasonable times.
- 18.4 The risk as to damage to the *property* passes to the purchaser immediately after the purchaser enters into possession.
- 18.5 If the purchaser does not comply with this clause, then without affecting any other right of the vendor –
- 18.5.1 the vendor can before completion, without notice, remedy the non-compliance; and
- 18.5.2 if the vendor pays the expense of doing this, the purchaser must pay it to the vendor with interest at the rate prescribed under s101 Civil Procedure Act 2005.
- 18.6 If this contract is *rescinded* or *terminated* the purchaser must immediately vacate the *property*.
- 18.7 If the *parties* or their *solicitors* on their behalf do not agree in writing to a fee or rent, none is payable.
- 19 Rescission of contract**
- 19.1 If this contract expressly gives a *party* a right to *rescind*, the *party* can exercise the right –
- 19.1.1 only by *servicing* a notice before completion; and
- 19.1.2 in spite of any making of a claim or *requisition*, any attempt to satisfy a claim or *requisition*, any arbitration, litigation, mediation or negotiation or any giving or taking of possession.
- 19.2 *Normally*, if a *party* exercises a right to *rescind* expressly given by this contract or any *legislation* –
- 19.2.1 the deposit and any other money paid by the purchaser under this contract must be refunded;
- 19.2.2 a *party* can claim for a reasonable adjustment if the purchaser has been in possession;
- 19.2.3 a *party* can claim for damages, costs or expenses arising out of a breach of this contract; and
- 19.2.4 a *party* will not otherwise be liable to pay the other *party* any damages, costs or expenses.

20 Miscellaneous

- 20.1 The *parties* acknowledge that anything stated in this contract to be attached was attached to this contract by the vendor before the purchaser signed it and is part of this contract.
- 20.2 Anything attached to this contract is part of this contract.
- 20.3 An area, bearing or dimension in this contract is only approximate.
- 20.4 If a *party* consists of 2 or more persons, this contract benefits and binds them separately and together.
- 20.5 A *party's solicitor* can receive any amount payable to the *party* under this contract or direct in writing that it is to be paid to another person.
- 20.6 A document under or relating to this contract is –
- 20.6.1 signed by a *party* if it is signed by the *party* or the *party's solicitor* (apart from a direction under clause 4.3);
- 20.6.2 served if it is served by the *party* or the *party's solicitor*;
- 20.6.3 served if it is served on the *party's solicitor*, even if the *party* has died or any of them has died;
- 20.6.4 served if it is served in any manner provided in s170 of the Conveyancing Act 1919;
- 20.6.5 served if it is sent by email or fax to the *party's solicitor*, unless in either case it is not received;
- 20.6.6 served on a person if it (or a copy of it) comes into the possession of the person; and
- 20.6.7 served at the earliest time it is served, if it is served more than once.
- 20.7 An obligation to pay an expense of another *party* of doing something is an obligation to pay –
- 20.7.1 if the *party* does the thing personally - the reasonable cost of getting someone else to do it; or
- 20.7.2 if the *party* pays someone else to do the thing - the amount paid, to the extent it is reasonable.
- 20.8 Rights under clauses 11, 13, 14, 17, 24, 30 and 31 continue after completion, whether or not other rights continue.
- 20.9 The vendor does not promise, represent or state that the purchaser has any cooling off rights.
- 20.10 The vendor does not promise, represent or state that any attached survey report is accurate or current.
- 20.11 A reference to any *legislation* (including any percentage or rate specified in *legislation*) is also a reference to any corresponding later *legislation*.
- 20.12 Each *party* must do whatever is necessary after completion to carry out the *party's* obligations under this contract.
- 20.13 Neither taking possession nor *serving* a transfer of itself implies acceptance of the *property* or the title.
- 20.14 The details and information provided in this contract (for example, on pages 1 - 3) are, to the extent of each *party's* knowledge, true, and are part of this contract.
- 20.15 Where this contract provides for choices, a choice in BLOCK CAPITALS applies unless a different choice is marked.

21 Time limits in these provisions

- 21.1 If the time for something to be done or to happen is not stated in these provisions, it is a reasonable time.
- 21.2 If there are conflicting times for something to be done or to happen, the latest of those times applies.
- 21.3 The time for one thing to be done or to happen does not extend the time for another thing to be done or to happen.
- 21.4 If the time for something to be done or to happen is the 29th, 30th or 31st day of a month, and the day does not exist, the time is instead the last day of the month.
- 21.5 If the time for something to be done or to happen is a day that is not a *business day*, the time is extended to the next *business day*, except in the case of clauses 2 and 3.2.
- 21.6 *Normally*, the time by which something must be done is fixed but not essential.

22 Foreign Acquisitions and Takeovers Act 1975

- 22.1 The purchaser promises that the Commonwealth Treasurer cannot prohibit and has not prohibited the transfer under the Foreign Acquisitions and Takeovers Act 1975.
- 22.2 This promise is essential and a breach of it entitles the vendor to *terminate*.

23 Strata or community title**• Definitions and modifications**

- 23.1 This clause applies only if the land (or part of it) is a lot in a strata, neighbourhood, precinct or community scheme (or on completion is to be a lot in a scheme of that kind).
- 23.2 In this contract –
- 23.2.1 'change', in relation to a scheme, means –
- a registered or registrable change from by-laws set out in this contract;
 - a change from a development or management contract or statement set out in this contract; or
 - a change in the boundaries of common property;
- 23.2.2 'common property' includes association property for the scheme or any higher scheme;
- 23.2.3 'contribution' includes an amount payable under a by-law;
- 23.2.4 'information certificate' includes a certificate under s184 Strata Schemes Management Act 2015 and s26 Community Land Management Act 1989;
- 23.2.5 'information notice' includes a strata information notice under s22 Strata Schemes Management Act 2015 and a notice under s47 Community Land Management Act 1989;

- 23.2.6 'normal expenses', in relation to an owners corporation for a scheme, means normal operating expenses usually payable from the administrative fund of an owners corporation for a scheme of the same kind;
- 23.2.7 'owners corporation' means the owners corporation or the association for the scheme or any higher scheme;
- 23.2.8 'the *property*' includes any interest in common property for the scheme associated with the lot; and
- 23.2.9 'special expenses', in relation to an owners corporation, means its actual, contingent or expected expenses, except to the extent they are –
- normal expenses;
 - due to fair wear and tear;
 - disclosed in this contract; or
 - covered by moneys held in the capital works fund.
- 23.3 Clauses 11, 14.8 and 18.4 do not apply to an obligation of the owners corporation, or to property insurable by it.
- 23.4 Clauses 14.4.2 and 14.5 apply but on a unit entitlement basis instead of an area basis.
- **Adjustments and liability for expenses**
- 23.5 The *parties* must adjust under clause 14.1 –
- 23.5.1 a regular periodic contribution;
- 23.5.2 a contribution which is not a regular periodic contribution but is disclosed in this contract; and
- 23.5.3 on a unit entitlement basis, any amount paid by the vendor for a normal expense of the owners corporation to the extent the owners corporation has not paid the amount to the vendor.
- 23.6 If a contribution is not a regular periodic contribution and is not disclosed in this contract –
- 23.6.1 the vendor is liable for it if it was determined on or before the contract date, even if it is payable by instalments; and
- 23.6.2 the purchaser is liable for all contributions determined after the contract date.
- 23.7 The vendor must pay or allow to the purchaser on completion the amount of any unpaid contributions for which the vendor is liable under clause 23.6.1.
- 23.8 *Normally*, the purchaser cannot make a claim or *requisition* or *rescind* or *terminate* in respect of –
- 23.8.1 an existing or future actual, contingent or expected expense of the owners corporation;
- 23.8.2 a proportional unit entitlement of the lot or a relevant lot or former lot, apart from a claim under clause 6; or
- 23.8.3 a past or future change in the scheme or a higher scheme.
- 23.9 However, the purchaser can *rescind* if –
- 23.9.1 the special expenses of the owners corporation at the later of the contract date and the creation of the owners corporation when calculated on a unit entitlement basis (and, if more than one lot or a higher scheme is involved, added together), less any contribution paid by the vendor, are more than 1% of the price;
- 23.9.2 in the case of the lot or a relevant lot or former lot in a higher scheme, a proportional unit entitlement for the lot is disclosed in this contract but the lot has a different proportional unit entitlement at the contract date or at any time before completion;
- 23.9.3 a change before the contract date or before completion in the scheme or a higher scheme materially prejudices the purchaser and is not disclosed in this contract; or
- 23.9.4 a resolution is passed by the owners corporation before the contract date or before completion to give to the owners in the scheme for their consideration a strata renewal plan that has not lapsed at the contract date and there is not attached to this contract a strata renewal proposal or the strata renewal plan.
- **Notices, certificates and inspections**
- 23.10 The purchaser must give the vendor 2 copies of an information notice addressed to the owners corporation and signed by the purchaser.
- 23.11 The vendor must complete and sign 1 copy of the notice and give it to the purchaser on completion.
- 23.12 Each *party* can sign and give the notice as agent for the other.
- 23.13 The vendor must serve an information certificate issued after the contract date in relation to the lot, the scheme or any higher scheme at least 7 days before the date for completion.
- 23.14 The purchaser does not have to complete earlier than 7 days after *service* of the certificate and clause 21.3 does not apply to this provision. On completion the purchaser must pay the vendor the prescribed fee for the certificate.
- 23.15 The vendor authorises the purchaser to apply for the purchaser's own certificate.
- 23.16 The vendor authorises the purchaser to apply for and make an inspection of any record or other document in the custody or control of the owners corporation or relating to the scheme or any higher scheme.
- **Meetings of the owners corporation**
- 23.17 If a general meeting of the owners corporation is convened before completion –
- 23.17.1 if the vendor receives notice of it, the vendor must immediately notify the purchaser of it; and
- 23.17.2 after the expiry of any cooling off period, the purchaser can require the vendor to appoint the purchaser (or the purchaser's nominee) to exercise any voting rights of the vendor in respect of the lot at the meeting.

24 Tenancies

- 24.1 If a tenant has not made a payment for a period preceding or current at the *adjustment date* –
- 24.1.1 for the purposes of clause 14.2, the amount is to be treated as if it were paid; and
- 24.1.2 the purchaser assigns the debt to the vendor on completion and will if required give a further assignment at the vendor's expense.
- 24.2 If a tenant has paid in advance of the *adjustment date* any periodic payment in addition to rent, it must be adjusted as if it were rent for the period to which it relates.
- 24.3 If the *property* is to be subject to a tenancy on completion or is subject to a tenancy on completion –
- 24.3.1 the vendor authorises the purchaser to have any accounting records relating to the tenancy inspected and audited and to have any other document relating to the tenancy inspected;
- 24.3.2 the vendor must *serve* any information about the tenancy reasonably requested by the purchaser before or after completion; and
- 24.3.3 *normally*, the purchaser can claim compensation (before or after completion) if –
- a disclosure statement required by the Retail Leases Act 1994 was not given when required;
 - such a statement contained information that was materially false or misleading;
 - a provision of the lease is not enforceable because of a non-disclosure in such a statement; or
 - the lease was entered into in contravention of the Retail Leases Act 1994.
- 24.4 If the *property* is subject to a tenancy on completion –
- 24.4.1 the vendor must allow or transfer –
- any remaining bond money or any other security against the tenant's default (to the extent the security is transferable);
 - any money in a fund established under the lease for a purpose and compensation for any money in the fund or interest earned by the fund that has been applied for any other purpose; and
 - any money paid by the tenant for a purpose that has not been applied for that purpose and compensation for any of the money that has been applied for any other purpose;
- 24.4.2 if the security is not transferable, each *party* must do everything reasonable to cause a replacement security to issue for the benefit of the purchaser, and the vendor must hold the original security on trust for the benefit of the purchaser until the replacement security issues;
- 24.4.3 the vendor must give to the purchaser –
- a proper notice of the transfer (an attornment notice) addressed to the tenant;
 - any certificate given under the Retail Leases Act 1994 in relation to the tenancy;
 - a copy of any disclosure statement given under the Retail Leases Act 1994;
 - a copy of any document served on the tenant under the lease and written details of its service, if the document concerns the rights of the landlord or the tenant after completion; and
 - any document served by the tenant under the lease and written details of its service, if the document concerns the rights of the landlord or the tenant after completion;
- 24.4.4 the vendor must comply with any obligation to the tenant under the lease, to the extent it is to be complied with by completion; and
- 24.4.5 the purchaser must comply with any obligation to the tenant under the lease, to the extent that the obligation is disclosed in this contract and is to be complied with after completion.

25 Qualified title, limited title and old system title

- 25.1 This clause applies only if the land (or part of it) –
- 25.1.1 is under qualified, limited or old system title; or
- 25.1.2 on completion is to be under one of those titles.
- 25.2 The vendor must *serve* a proper abstract of title *within 7 days* after the contract date.
- 25.3 If an abstract of title or part of an abstract of title is attached to this contract or has been lent by the vendor to the purchaser before the contract date, the abstract or part is *served* on the contract date.
- 25.4 An abstract of title can be or include a list of documents, events and facts arranged (apart from a will or codicil) in date order, if the list in respect of each document –
- 25.4.1 shows its date, general nature, names of parties and any registration number; and
- 25.4.2 has attached a legible photocopy of it or of an official or registration copy of it.
- 25.5 An abstract of title –
- 25.5.1 must start with a good root of title (if the good root of title must be at least 30 years old, this means 30 years old at the contract date);
- 25.5.2 in the case of a leasehold interest, must include an abstract of the lease and any higher lease;
- 25.5.3 *normally*, need not include a Crown grant; and
- 25.5.4 need not include anything evidenced by the Register kept under the Real Property Act 1900.
- 25.6 In the case of land under old system title –
- 25.6.1 in this contract 'transfer' means conveyance;
- 25.6.2 the purchaser does not have to *serve* the form of transfer until after the vendor has *served* a proper abstract of title; and
- 25.6.3 each vendor must give proper covenants for title as regards that vendor's interest.
- 25.7 In the case of land under limited title but not under qualified title –

- 25.7.1 normally, the abstract of title need not include any document which does not show the location, area or dimensions of the land (for example, by including a metes and bounds description or a plan of the land);
- 25.7.2 clause 25.7.1 does not apply to a document which is the good root of title; and
- 25.7.3 the vendor does not have to provide an abstract if this contract contains a delimitation plan (whether in registrable form or not).
- 25.8 The vendor must give a proper covenant to produce where relevant.
- 25.9 The vendor does not have to produce or covenant to produce a document that is not in the possession of the vendor or a mortgagee.
- 25.10 If the vendor is unable to produce an original document in the chain of title, the purchaser will accept a photocopy from the Registrar-General of the registration copy of that document.
- 26 Crown purchase money**
- 26.1 This clause applies only if purchase money is payable to the Crown, whether or not due for payment.
- 26.2 The vendor is liable for the money, except to the extent this contract says the purchaser is liable for it.
- 26.3 To the extent the vendor is liable for it, the vendor is liable for any interest until completion.
- 26.4 To the extent the purchaser is liable for it, the *parties* must adjust any interest under clause 14.1.
- 27 Consent to transfer**
- 27.1 This clause applies only if the land (or part of it) cannot be transferred without consent under *legislation* or a *planning agreement*.
- 27.2 The purchaser must properly complete and then serve the purchaser's part of an application for consent to transfer of the land (or part of it) *within 7 days* after the contract date.
- 27.3 The vendor must apply for consent *within 7 days* after *service* of the purchaser's part.
- 27.4 If consent is refused, either *party* can *rescind*.
- 27.5 If consent is given subject to one or more conditions that will substantially disadvantage a *party*, then that *party* can *rescind within 7 days* after receipt by or *service* upon the *party* of written notice of the conditions.
- 27.6 If consent is not given or refused –
- 27.6.1 *within 42 days* after the purchaser serves the purchaser's part of the application, the purchaser can *rescind*; or
- 27.6.2 *within 30 days* after the application is made, either *party* can *rescind*.
- 27.7 Each period in clause 27.6 becomes 90 days if the land (or part of it) is –
- 27.7.1 under a *planning agreement*; or
- 27.7.2 in the Western Division.
- 27.8 If the land (or part of it) is described as a lot in an unregistered plan, each time in clause 27.6 becomes the later of the time and 35 days after creation of a separate folio for the lot.
- 27.9 The date for completion becomes the later of the date for completion and 14 days after *service* of the notice granting consent to transfer.
- 28 Unregistered plan**
- 28.1 This clause applies only if some of the land is described as a lot in an unregistered plan.
- 28.2 The vendor must do everything reasonable to have the plan registered *within 6 months* after the contract date, with or without any minor alteration to the plan or any document to be lodged with the plan validly required or made under *legislation*.
- 28.3 If the plan is not registered *within* that time and in that manner –
- 28.3.1 the purchaser can *rescind*; and
- 28.3.2 the vendor can *rescind*, but only if the vendor has complied with clause 28.2 and with any *legislation* governing the rescission.
- 28.4 Either *party* can *serve* notice of the registration of the plan and every relevant lot and plan number.
- 28.5 The date for completion becomes the later of the date for completion and 21 days after *service* of the notice.
- 28.6 Clauses 28.2 and 28.3 apply to another plan that is to be registered before the plan is registered.
- 29 Conditional contract**
- 29.1 This clause applies only if a provision says this contract or completion is conditional on an event.
- 29.2 If the time for the event to happen is not stated, the time is 42 days after the contract date.
- 29.3 If this contract says the provision is for the benefit of a *party*, then it benefits only that *party*.
- 29.4 If anything is necessary to make the event happen, each *party* must do whatever is reasonably necessary to cause the event to happen.
- 29.5 A *party* can *rescind* under this clause only if the *party* has substantially complied with clause 29.4.
- 29.6 If the event involves an approval and the approval is given subject to a condition that will substantially disadvantage a *party* who has the benefit of the provision, the *party* can *rescind within 7 days* after either *party* serves notice of the condition.
- 29.7 If the *parties* can lawfully complete without the event happening –
- 29.7.1 if the event does not happen *within* the time for it to happen, a *party* who has the benefit of the provision can *rescind within 7 days* after the end of that time;
- 29.7.2 if the event involves an approval and an application for the approval is refused, a *party* who has the benefit of the provision can *rescind within 7 days* after either *party* serves notice of the refusal; and

- 29.7.3 the date for completion becomes the later of the date for completion and 21 days after the earliest of –
- either *party* serving notice of the event happening;
 - every *party* who has the benefit of the provision serving notice waiving the provision; or
 - the end of the time for the event to happen.
- 29.8 If the *parties* cannot lawfully complete without the event happening –
- 29.8.1 if the event does not happen *within* the time for it to happen, either *party* can *rescind*;
- 29.8.2 if the event involves an approval and an application for the approval is refused, either *party* can *rescind*;
- 29.8.3 the date for completion becomes the later of the date for completion and 21 days after either *party* serves notice of the event happening.
- 29.9 A *party* cannot *rescind* under clauses 29.7 or 29.8 after the event happens.
- 30 Electronic transaction**
- 30.1 This *Conveyancing Transaction* is to be conducted as an *electronic transaction* if –
- 30.1.1 this contract says that it is an *electronic transaction*;
- 30.1.2 the *parties* otherwise agree that it is to be conducted as an *electronic transaction*; or
- 30.1.3 the *conveyancing rules* require it to be conducted as an *electronic transaction*.
- 30.2 However, this *Conveyancing Transaction* is not to be conducted as an *electronic transaction* –
- 30.2.1 if the land is not *electronically tradeable* or the transfer is not eligible to be lodged electronically; or
- 30.2.2 if, at any time after the *effective date*, but at least 14 days before the date for completion, a *party* serves a notice stating a valid reason why it cannot be conducted as an *electronic transaction*.
- 30.3 If, because of clause 30.2.2, this *Conveyancing Transaction* is not to be conducted as an *electronic transaction* –
- 30.3.1 each *party* must –
- bear equally any disbursements or fees; and
 - otherwise bear that *party's* own costs;
- incurred because this *Conveyancing Transaction* was to be conducted as an *electronic transaction*; and
- 30.3.2 if a *party* has paid all of a disbursement or fee, which, by reason of this clause, is to be borne equally by the *parties*, that amount must be adjusted under clause 14.2.
- 30.4 If this *Conveyancing Transaction* is to be conducted as an *electronic transaction* –
- 30.4.1 to the extent that any other provision of this contract is inconsistent with this clause, the provisions of this clause prevail;
- 30.4.2 *normally*, words and phrases used in this clause 30 (italicised and in Title Case, such as *Electronic Workspace* and *Lodgment Case*) have the same meaning which they have in the *participation rules*;
- 30.4.3 the *parties* must conduct the *electronic transaction* –
- in accordance with the *participation rules* and the *ECNL*; and
 - using the nominated *ELN*, unless the *parties* otherwise agree;
- 30.4.4 a *party* must pay the fees and charges payable by that *party* to the *ELNO* and the *Land Registry* as a result of this transaction being an *electronic transaction*;
- 30.4.5 any communication from one *party* to another *party* in the *Electronic Workspace* made –
- after the *effective date*; and
 - before the receipt of a notice given under clause 30.2.2;
- is taken to have been received by that *party* at the time determined by s13A of the *Electronic Transactions Act 2000*; and
- 30.4.6 a document which is an *electronic document* is served as soon as it is first *Digitally Signed* in the *Electronic Workspace* on behalf of the *party* required to serve it.
- 30.5 *Normally*, the vendor must *within 7 days of the effective date* –
- 30.5.1 create an *Electronic Workspace*;
- 30.5.2 *populate* the *Electronic Workspace* with *title data*, the date for completion and, if applicable, *mortgagee details*; and
- 30.5.3 invite the purchaser and any *discharging mortgagee* to the *Electronic Workspace*.
- 30.6 If the vendor has not created an *Electronic Workspace* in accordance with clause 30.5, the purchaser may create an *Electronic Workspace*. If the purchaser creates the *Electronic Workspace* the purchaser must –
- 30.6.1 *populate* the *Electronic Workspace* with *title data*;
- 30.6.2 create and *populate* an *electronic transfer*;
- 30.6.3 *populate* the *Electronic Workspace* with the date for completion and a nominated *completion time*; and
- 30.6.4 invite the vendor and any *incoming mortgagee* to join the *Electronic Workspace*.
- 30.7 *Normally*, *within 7 days* of receiving an invitation from the vendor to join the *Electronic Workspace*, the purchaser must –
- 30.7.1 join the *Electronic Workspace*;
- 30.7.2 create and *populate* an *electronic transfer*;
- 30.7.3 invite any *incoming mortgagee* to join the *Electronic Workspace*; and
- 30.7.4 *populate* the *Electronic Workspace* with a nominated *completion time*.

- 30.8 If the purchaser has created the *Electronic Workspace* the vendor must *within 7 days* of being invited to the *Electronic Workspace* –
- 30.8.1 join the *Electronic Workspace*;
- 30.8.2 populate the *Electronic Workspace* with mortgagee details, if applicable; and
- 30.8.3 invite any discharging mortgagee to join the *Electronic Workspace*.
- 30.9 To complete the financial settlement schedule in the *Electronic Workspace* –
- 30.9.1 the purchaser must provide the vendor with *adjustment figures* at least 2 *business days* before the date for completion;
- 30.9.2 the vendor must confirm the *adjustment figures* at least 1 *business day* before the date for completion; and
- 30.9.3 if the purchaser must make a *GSTRW payment* or an *FRCGW remittance*, the purchaser must populate the *Electronic Workspace* with the payment details for the *GSTRW payment* or *FRCGW remittance* payable to the Deputy Commissioner of Taxation at least 2 *business days* before the date for completion.
- 30.10 Before completion, the parties must ensure that –
- 30.10.1 all *electronic documents* which a party must *Digitally Sign* to complete the *electronic transaction* are populated and *Digitally Signed*;
- 30.10.2 all certifications required by the *ECNL* are properly given; and
- 30.10.3 they do everything else in the *Electronic Workspace* which that party must do to enable the *electronic transaction* to proceed to completion.
- 30.11 If completion takes place in the *Electronic Workspace* –
- 30.11.1 payment electronically on completion of the price in accordance with clause 16.7 is taken to be payment by a single *settlement cheque*;
- 30.11.2 the completion address in clause 16.11 is the *Electronic Workspace*; and
- 30.11.3 clauses 13.13.2 to 13.13.4, 16.8, 16.12, 16.13 and 31.2.2 to 31.2.4 do not apply.
- 30.12 If the computer systems of any of the *Land Registry*, the *ELNO* or the Reserve Bank of Australia are inoperative for any reason at the *completion time* agreed by the parties, a failure to complete this contract for that reason is not a default under this contract on the part of either party.
- 30.13 If the computer systems of the *Land Registry* are inoperative for any reason at the *completion time* agreed by the parties, and the parties choose that financial settlement is to occur despite this, then on financial settlement occurring –
- 30.13.1 all *electronic documents Digitally Signed* by the vendor, the *certificate of title* and any discharge of mortgage, withdrawal of caveat or other *electronic document* forming part of the *Lodgment Case* for the *electronic transaction* shall be taken to have been unconditionally and irrevocably delivered to the purchaser or the purchaser's mortgagee at the time of financial settlement together with the right to deal with the land comprised in the *certificate of title*; and
- 30.13.2 the vendor shall be taken to have no legal or equitable interest in the *property*.
- 30.14 A party who holds a *certificate of title* must act in accordance with any *Prescribed Requirement* in relation to the *certificate of title* but if there is no *Prescribed Requirement*, the vendor must serve the *certificate of title* after completion.
- 30.15 If the parties do not agree about the delivery before completion of one or more documents or things that cannot be delivered through the *Electronic Workspace*, the party required to deliver the documents or things –
- 30.15.1 holds them on completion in escrow for the benefit of; and
- 30.15.2 must immediately after completion deliver the documents or things to, or as directed by; the party entitled to them.
- 30.16 In this clause 30, these terms (in any form) mean –
- adjustment figures* details of the adjustments to be made to the price under clause 14;
- certificate of title* the paper duplicate of the folio of the register for the land which exists immediately prior to completion and, if more than one, refers to each such paper duplicate;
- completion time* the time of day on the date for completion when the *electronic transaction* is to be settled;
- conveyancing rules* the rules made under s12E of the Real Property Act 1900;
- discharging mortgagee* any discharging mortgagee, chargee, covenant chargee or caveator whose provision of a *Digitally Signed* discharge of mortgage, discharge of charge or withdrawal of caveat is required in order for unencumbered title to the *property* to be transferred to the purchaser;
- ECNL* the Electronic Conveyancing National Law (NSW);
- effective date* the date on which the *Conveyancing Transaction* is agreed to be an *electronic transaction* under clause 30.1.2 or, if clauses 30.1.1 or 30.1.3 apply, the contract date;
- electronic document* a dealing as defined in the Real Property Act 1900 which may be created and *Digitally Signed* in an *Electronic Workspace*;
- electronic transfer* a transfer of land under the Real Property Act 1900 for the *property* to be prepared and *Digitally Signed* in the *Electronic Workspace* established for the purposes of the parties' *Conveyancing Transaction*;

<i>electronic transaction</i>	a <i>Conveyancing Transaction</i> to be conducted for the <i>parties</i> by their legal representatives as <i>Subscribers</i> using an <i>ELN</i> and in accordance with the <i>ECNL</i> and the <i>participation rules</i> ;
<i>electronically tradeable</i>	a land title that is Electronically Tradeable as that term is defined in the <i>conveyancing rules</i> ;
<i>incoming mortgagee</i>	any mortgagee who is to provide finance to the purchaser on the security of the <i>property</i> and to enable the purchaser to pay the whole or part of the price;
<i>mortgagee details</i>	the details which a <i>party</i> to the <i>electronic transaction</i> must provide about any <i>discharging mortgagee</i> of the <i>property</i> as at completion;
<i>participation rules</i>	the participation rules as determined by the <i>ECNL</i> ;
<i>populate</i>	to complete data fields in the <i>Electronic Workspace</i> ; and
<i>title data</i>	the details of the title to the <i>property</i> made available to the <i>Electronic Workspace</i> by the <i>Land Registry</i> .

31 Foreign Resident Capital Gains Withholding

- 31.1 This clause applies only if –
- 31.1.1 the sale is not an excluded transaction within the meaning of s14-215 of Schedule 1 to the *TA Act*; and
- 31.1.2 a *clearance certificate* in respect of every vendor is not attached to this contract.
- 31.2 The purchaser must –
- 31.2.1 at least 5 days before the date for completion, *serve* evidence of submission of a purchaser payment notification to the Australian Taxation Office by the purchaser or, if a direction under clause 4.3 has been *served*, by the transferee named in the transfer *served* with that direction;
- 31.2.2 produce on completion a *settlement cheque* for the *FRCGW remittance* payable to the Deputy Commissioner of Taxation;
- 31.2.3 forward the *settlement cheque* to the payee immediately after completion; and
- 31.2.4 *serve* evidence of receipt of payment of the *FRCGW remittance*.
- 31.3 The vendor cannot refuse to complete if the purchaser complies with clauses 31.2.1 and 31.2.2.
- 31.4 If the vendor *serves* any *clearance certificate* or *variation*, the purchaser does not have to complete earlier than 7 days after that *service* and clause 21.3 does not apply to this provision.
- 31.5 If the vendor *serves* in respect of every vendor either a *clearance certificate* or a *variation* to 0.00 percent, clauses 31.2 and 31.3 do not apply.

32 Residential off the plan contract

- 32.1 This clause applies if this contract is an off the plan contract within the meaning of Division 10 of Part 4 of the *Conveyancing Act 1919* (the *Division*).
- 32.2 No provision of this contract has the effect of excluding, modifying or restricting the operation of the *Division*.
- 32.3 If the purchaser makes a claim for compensation under the terms prescribed by clause 6A of the *Conveyancing (Sale of Land) Regulation 2017* –
- 32.3.1 the purchaser cannot make a claim under this contract about the same subject matter, including a claim under clauses 6 or 7; and
- 32.3.2 the claim for compensation is not a claim under this contract.
- 32.4 This clause does not apply to a contract made before the commencement of the amendments to the *Division* under the *Conveyancing Legislation Amendment Act 2018*.

SPECIAL CONDITIONS FORMING PART OF THE CONTRACT

VENDOR: Katrina Maree Burg

ADDRESS OF PROPERTY: Unit 2/9A Walter Street, Rutherford, New South Wales 2320

1 Purchaser's warranty as to real estate agent

- 1.1 The purchaser warrants that the purchaser was not introduced to the property or the Vendor by a Real Estate Agent other than the Real Estate Agent, if any, disclosed on the front page of the contract and the purchaser agrees to indemnify the Vendor against any claim for commission, including the Vendor's costs of defending any such claim, which arises as a result of the purchaser's breach of this warranty;
- 1.2 This warranty and indemnity will not merge on completion;
- 1.3 The Vendor warrants that he has not entered into a sole or exclusive agency agreement as at the date hereto with any agent other than the agent named on the front page of the contract.

2 Liquidated damages

- 2.1 In the event that the Purchaser does not complete this contract on or before the completion date, and provided the Vendor is ready and willing to complete the contract, then the Purchaser shall from that date pay interest on the balance of the purchase price at the rate of 8% pa until completion.
- 2.2 In the event that the Vendor serves a Notice to Complete, the sum of \$330.00 on account of the additional legal fees incurred by the Vendor because of the delay;
- 2.3 The Purchaser acknowledges that the payment of the liquidated damages referred to herein is contemporaneous with the payment of the purchase price on settlement. It is agreed that the amount payable pursuant to this condition is a genuine pre-estimate of the Vendors' loss of interest for the purchase money and liability for rates and outgoings.

3 Time Under Notice

The parties agree that 14 days shall be reasonable notice for the purpose of any notice served by either party, including a notice to complete, making time of the essence.

4 Present Condition and State of Repair

(a) The Purchaser acknowledges that the property is being purchased: -

- In its present condition and state of repair;
- With any defects regarding construction or repair of any improvements thereon;
- Subject to any infestation and dilapidation; and

- In reliance upon the Purchaser's own inspection or the inspection of others engaged by the Purchaser.
- (b) The Purchaser further acknowledges that the Vendor has not, nor has anyone on the Vendor's behalf, made any representation or warranty as to the fitness, for any purpose of any part of the property other than as contained in this Contract.
- (c) The Purchaser must, at completion, accept the property in its present state of condition and repair at the Contract date, subject to fair wear and tear.

5 Condition of Inclusions

5.1 The inclusions listed on the front page of Contract are included in the purchase and the purchase price. The Purchaser:

- (a) acknowledges that none of the inclusions are new;
- (b) acknowledges that the Vendor has not made and does not make any representation or warranty as to the state of repair or condition of the inclusions; and
- (c) Shall accept the inclusions on the date on which the Purchaser is entitled to possession of the property in their current state of repair and condition, including reasonable fair wear and tear during the Contract period.

5.2 The Purchaser acknowledges that the title to the inclusions shall pass to the Purchaser on completion of this Contract and the Vendor shall not be required to give formal delivery of the inclusions to the Purchaser. The Vendor shall not be responsible for any mechanical breakdown after the making of this Contract in respect of any inclusions.

6 Death and Mental Illness

If the Vendor or Purchaser or any one or more of them shall die or become mentally ill pursuant to the *Mental Health Act 2007 No 8* prior to completion of this Contract, then either party may by notice in writing to the other party's legal representative may rescind this contract whereupon the provisions of clause 19 shall apply.

7 Requisitions on Title

The Purchaser agrees that the only form of general Requisitions on Title the Purchaser may make pursuant to Clause 5 shall be in the form of the Requisitions on Title annexed hereto.

8 Counterpart and Electronic Contract

- 8.1 This Contract may be signed in any number of counterparts with the same effect as if the signatures to each counterpart were on the same instrument;
- 8.2 Execution by the parties of the Contract by email or electronically via docusign and transmission of the executed Contract by either of those means shall constitute a valid and binding execution of this Contract by such part or parties.

8.3 For the purposes of the *Electronic Transaction Act 1999* (CTH) and *Electronic Transactions Act 2000* (NSW) each party consents to receiving and sending the Contract electronically.

8.4 The purchaser acknowledges that an original 'ink' signed copy of the vendors signed contract will not be provided.

9 Sewer Diagram – Hunter Water

9.1 The Vendor discloses, and the purchaser specifically acknowledges that the diagram annexed to the Contract may only disclose the sewer main and, as at the date of this Contract, this is the only diagram available for the property from Hunter Water.

9.2 The Purchaser accepts this diagram and shall make their own inquiries in relation to the services and the diagram. The Purchaser agrees to not call upon the Vendor to supply an updated diagram nor make any objection, requisition or claim, delay completion, rescind or terminate the Contract in respect of any matter disclosed in or arising from this clause.

10 GST - Residential

The Purchaser warrants that the property will be used predominately for residential accommodation. The Purchaser will indemnify the Vendor against any liability to pay GST arising from breach of this warranty. This clause shall not merge on completion.

11 Tenancy

11.1 Clause 29 of the Contract is deleted.

11.2 If a tenant is in occupation of the property, and if page one (1) of this Contract provides for the Vendor to give Vacant Possession of the property on completion of this Contract, then the following provisions shall apply:

- (a) Completion of this Contract is conditional upon the Vendor obtaining Vacant Possession of the property from the tenant.
- (b) The Vendor shall forthwith serve Notice to Vacate on the tenant and will pursue that notice; and
- (c) Neither party will be entitled to serve a Notice to Complete on the other party until a period of 42 days from the original Contract completion date has lapsed.

12 Deposit Paid by Instalments

12.1 The purchaser acknowledges and agrees that the deposit payable under this Contract is 10% of the purchase price. The vendor has agreed to allow the purchaser to pay the 10% deposit payable under this Contract in two instalments, as follows:

- (a) as to 50% of the deposit payable on the date of this Contract (time being of the essence); and
- (b) the remaining 50% of the deposit payable on the earlier of (time being of the essence):
 - (i) termination of this Contract by the vendor for a breach committed by the purchaser; and
 - (ii) the completion of this Contract.

12.2 The purchaser acknowledges that the vendor has agreed to accept the deposit by instalments at the purchaser's request in earnest of the bargain this Contract and its performance by the purchaser. The purchaser acknowledges that it is an essential term of this Contract that the vendor be entitled to recover from the purchaser the full 10% deposit should the purchaser default under this Contract.

12.3 If subclause 12.1 applies:

- (a) so much of the deposit not paid by the purchaser on the date of this Contract is a liquidated debt due and payable by the purchaser to the vendor; and
- (b) that debt must be repaid to the vendor on the earlier of:
 - (i) the vendor becoming entitled to the deposit under this Contract; and
 - (ii) completion of this Contract.

12.4 The purchaser acknowledges and agrees that in the circumstances entitling the vendor to forfeit the 10% deposit, then this amount represents a genuine pre-estimate of the vendor's loss and not a penalty.

12.5 Nothing in this clause shall be taken as restricting the vendor's rights under this contract or at law. The vendor's right under this clause 13 shall continue notwithstanding termination of the Contract for a breach by the purchaser.

13 Release of Deposit

Notwithstanding any provision contained herein to the contrary, the Purchaser hereby agrees and acknowledges that by their execution of this Contract they irrevocably authorise the vendor's agent to release to the vendor the whole or any part of the deposit paid herein to the vendor to use as a deposit and/or stamp duty on any piece of real estate that the vendor negotiates to purchase between the date hereof and the date of completion PROVIDED THAT the vendor does not permit the further release of such deposit without the purchaser's consent. This clause shall be sufficient authority to the agent to release the deposit as aforesaid.

14 Extension(s) to Cooling Off Period and/or Finance Clause

If a cooling off period or finance clause applies to this Contract then on the second and each subsequent occasion that the purchaser requests an extension thereof irrespective of whether the request is granted by the vendor, the purchaser must on completion pay a

further sum of \$220.00 inclusive of GST for the vendor's additional legal costs associated with the purchaser's request(s). This fee is agreed by the parties to be a genuine and reasonable pre-estimate of the Vendor's actual costs. The payment of this fee is an essential term of the completion of this Contract.

15 Guarantee & Indemnity for Corporate Purchaser

If the Purchaser (and if comprising more than one person, any one or more of them) is a company, and in consideration of the Vendor entering into this Contract with the Purchaser, it is an essential provision of this Contract that the Directors of the Purchaser jointly and severally guarantee to the Vendor the due and punctual performance and observance by the Purchaser of its obligations under this Contract and indemnify the Vendor against all losses, damages, liabilities, costs and expenses accruing to the Vendor resulting or arising from any failure by the Purchaser to perform or observe any of the obligation on its part to be performed or observed. This Guarantee and Indemnity is a continuing obligation and cannot be abrogated, prejudiced, or discharged by any waiver by the vendor or by any other matter. Any rescission or termination will not waive the obligations arising under this clause. This Guarantee and Indemnity is a principal obligation between the Guarantor and the Vendor.

Signed by Guarantor:

.....

.....

Signature of Guarantor

In the presence of:

.....

.....

Signature of Witness

Signature of Guarantor

.....

Name of Witness

.....

Address of Witness

RESIDENTIAL PROPERTY REQUISITIONS ON TITLE

Possession and tenancies

- 1 Vacant possession of the property must be given on completion unless the Contract provides otherwise.
- 2 Is anyone in adverse possession of the property or any part of it?
- 3 (a) What are the nature and provisions of any tenancy or occupancy?
(b) If they are in writing, all relevant documentation should be produced, found in order and handed over on completion with notices of attornment.
(c) Please specify any existing breaches.
(d) All rent should be paid up to or beyond the date of completion.
(e) Please provide details of any bond together with the Rental Bond Board's reference number.
(f) If any bond money is held by the Rental Bond Board, the appropriate transfer documentation duly signed should be handed over on completion.
- 4 Is the property affected by a protected tenancy? (A tenancy affected by Parts 2, 3, 4 or 5 of the Landlord and Tenant (Amendment) Act 1948.)
- 5 If the tenancy is subject to the Residential Tenancies Act 1987:
(a) has either the vendor or any predecessor or the tenant applied to the Residential Tenancies Tribunal for an order?
(b) have any orders been made by the Residential Tenancies Tribunal? If so, please provide details.

Title

- 6 Subject to the Contract, on completion the vendor should be registered as proprietor in fee simple of the property free from all encumbrances.
- 7 On or before completion, any mortgage or caveat must be discharged or withdrawn (as the case may be) or an executed discharge or withdrawal handed over on completion.
- 8 When and where may the title documents be inspected?
- 9 Are the inclusions or fixtures subject to any charge or hiring agreement? If so, details must be given and any indebtedness discharged prior to completion or title transferred unencumbered to the vendor prior to completion.

Adjustments

- 10 All outgoings referred to in clause 14.1 of the Contract must be paid up to and including the date of completion.
- 11 Is the vendor liable to pay land tax or is the property otherwise charged or liable to be charged with land tax? If so:
(a) to what year has a return been made?
(b) what is the taxable value of the property for land tax purposes for the current year?

Survey and building

- 12 Subject to the Contract, survey should be satisfactory and show that the whole of the property is available and that there are no encroachments by or upon the property and that all improvements comply with local government/planning legislation.
- 13 Is the vendor in possession of a survey report? If so, please produce a copy for inspection prior to completion. The original should be handed over on completion.
- 14 (a) Have the provisions of the Local Government Act, the Environmental Planning and Assessment Act 1979 and their regulations been complied with?

- (b) Is there any matter that could justify the making of an upgrading or demolition order in respect of any building or structure?
 - (c) Has the vendor a Building Certificate which relates to all current buildings or structures? If so, it should be handed over on completion. Please provide a copy in advance.
 - (d) Has the vendor a Final Occupation Certificate issued under the Environmental Planning and Assessment Act 1979 for all current buildings or structures? If so, it should be handed over on completion. Please provide a copy in advance.
 - (e) In respect of any residential building work carried out in the last 7 years:
 - (i) please identify the building work carried out;
 - (ii) when was the building work completed?
 - (iii) please state the builder's name and licence number;
 - (iv) please provide details of insurance under the Home Building Act 1989.
15. Has the vendor (or any predecessor) entered into any agreement with or granted any indemnity to the Council or any other authority concerning any development on the property?
16. If a swimming pool is included in the property:
- (a) when did construction of the swimming pool commence?
 - (b) is the swimming pool surrounded by a barrier which complies with the requirements of the Swimming Pools Act 1992?
 - (c) if the swimming pool has been approved under the Local Government Act 1993, please provide details.
 - (d) are there any outstanding notices or orders?
17. (a) To whom do the boundary fences belong?
- (b) Are there any party walls?
 - (c) If the answer to (b) is yes, specify what rights exist in relation to each party wall and produce any agreement. The benefit of any such agreement should be assigned to the purchaser on completion.
 - (d) Is the vendor aware of any dispute regarding boundary or dividing fences or party walls?
 - (e) Has the vendor received any notice, claim or proceedings under the Dividing Fences Act 1991 or the Encroachment of Buildings Act 1922?

Affectations

18. Is the vendor aware of any rights, licences, easements, covenants or restrictions as to use other than those disclosed in the Contract?
19. Is the vendor aware of:
- (a) any road, drain, sewer or storm water channel which intersects or runs through the land?
 - (b) any dedication to or use by the public of any right of way or other easement over any part of the land?
 - (c) any latent defects in the property?
20. Has the vendor any notice or knowledge that the property is affected by the following:
- (a) any resumption or acquisition or proposed resumption or acquisition?

- (b) any notice requiring work to be done or money to be spent on the property or any footpath or road adjoining? If so, such notice must be complied with prior to completion.
 - (c) any work done or intended to be done on the property or the adjacent street which may create a charge on the property or the cost of which might be or become recoverable from the purchaser?
 - (d) any sum due to any local or public authority? If so, it must be paid prior to completion.
 - (e) any realignment or proposed realignment of any road adjoining the property?
 - (f) any contamination?
21. (a) Does the property have the benefit of water, sewerage, drainage, electricity, gas and telephone services?
- (b) If so, do any of the connections for such services pass through any adjoining land?
- (c) Do any service connections for any other property pass through the property?
22. Has any claim been made by any person to close, obstruct or limit access to or from the property or to an easement over any part of the property?

Capacity

23. If the Contract discloses that the vendor is a trustee, evidence should be produced to establish the trustee's power of sale.

Requisitions and transfer

24. If the transfer or any other document to be handed over on completion is executed pursuant to a power of attorney, then at least 7 days prior to completion a copy of the registered power of attorney should be produced and found in order.
25. If the vendor has or is entitled to have possession of the title deeds the Certificate Authentication Code must be provided 7 days prior to settlement.
26. Searches, surveys, enquiries and inspection of title deeds must prove satisfactory.
27. The purchaser reserves the right to make further requisitions prior to completion.
28. Unless we are advised by you to the contrary prior to completion, it will be assumed that your replies to these requisitions remain unchanged as at completion date.



NEW SOUTH WALES LAND REGISTRY SERVICES - TITLE SEARCH

FOLIO: 131/1120704

SEARCH DATE	TIME	EDITION NO	DATE
-----	----	-----	----
12/7/2021	11:15 AM	5	12/5/2020

LAND

LOT 131 IN DEPOSITED PLAN 1120704
AT RUTHERFORD
LOCAL GOVERNMENT AREA MAITLAND
PARISH OF MAITLAND COUNTY OF NORTHUMBERLAND
TITLE DIAGRAM DP1120704

FIRST SCHEDULE

(CN AQ94630)

SECOND SCHEDULE (14 NOTIFICATIONS)

- 1 RESERVATIONS AND CONDITIONS IN THE CROWN GRANT(S)
- 2 DP1071878 EASEMENT TO DRAIN WATER 2.5 METRE(S) WIDE AND VARIABLE AFFECTING THE PART(S) SHOWN SO BURDENED IN THE TITLE DIAGRAM
- 3 DP1071878 EASEMENT TO DRAIN WATER 2.5 METRE(S) WIDE AND VARIABLE APPURTENANT TO THE LAND ABOVE DESCRIBED
- 4 DP1071878 RIGHT OF CARRIAGEWAY 3.5 METRE(S) WIDE AFFECTING THE PART(S) SHOWN SO BURDENED IN THE TITLE DIAGRAM
- 5 DP1071878 RIGHT OF CARRIAGEWAY 3.5 METRE(S) WIDE APPURTENANT TO THE LAND ABOVE DESCRIBED
- 6 DP1071878 RESTRICTION(S) ON THE USE OF LAND REFERRED TO AND NUMBERED (7) IN THE S.88B INSTRUMENT
- 7 DP1071878 EASEMENT FOR SERVICES 3.5 METRE(S) WIDE AFFECTING THE PART(S) SHOWN SO BURDENED IN THE TITLE DIAGRAM
- 8 DP1071878 EASEMENT FOR SERVICES 3.5 METRE(S) WIDE APPURTENANT TO THE LAND ABOVE DESCRIBED
- 9 DP1071878 RESTRICTION(S) ON THE USE OF LAND REFERRED TO AND NUMBERED (10) IN THE S.88B INSTRUMENT
- 10 DP1071878 RESTRICTION(S) ON THE USE OF LAND REFERRED TO AND NUMBERED (11) IN THE S.88B INSTRUMENT
- 11 DP1120704 RIGHT OF CARRIAGEWAY VARIABLE WIDTH AFFECTING THE PART(S) SHOWN SO BURDENED IN THE TITLE DIAGRAM
- 12 DP1120704 RIGHT OF CARRIAGEWAY VARIABLE WIDTH APPURTENANT TO THE LAND ABOVE DESCRIBED
- 13 DP1120704 EASEMENT FOR OVERHANG 0.15 METRE(S) WIDE APPURTENANT TO THE LAND ABOVE DESCRIBED
- 14 AQ94629 MORTGAGE TO AFSH NOMINEES PTY LTD

END OF PAGE 1 - CONTINUED OVER

NEW SOUTH WALES LAND REGISTRY SERVICES - TITLE SEARCH

FOLIO: 131/1120704

PAGE 2

NOTATIONS

UNREGISTERED DEALINGS: NIL

*** END OF SEARCH ***

2021/3028

PRINTED ON 12/7/2021

* Any entries preceded by an asterisk do not appear on the current edition of the Certificate of Title. Warning: the information appearing under notations has not been formally recorded in the Register. InfoTrack an approved NSW Information Broker hereby certifies that the information contained in this document has been provided electronically by the Registrar General in accordance with Section 96B(2) of the Real Property Act 1900.

Copyright © Office of the Registrar-General 2021

Received: 12/07/2021 11:16:05

FOR SIGNATURES, SEALS AND CERTIFICATES SEE SIGNATURES FORM

SHORT LINE TABLE

LINE	BEARING	DISTANCE	ARC	RADIUS
1	S 72° 28' 51" E	8.2	0.85	20
2	T 40° 15' 1" E	0.755	0.35	20
3	S 28° 03' 35" E	1.75	0.35	20
4	S 28° 03' 35" E	2.71	1.975	20
5	S 28° 03' 35" E	1.975	1.975	20
6	S 98° 17' 15" E	0.355		

- (A) EASEMENT TO DRAIN WATER, 4.5 WIDE & VARIABLE (DP107878)
- (B) RIGHT OF CARRIAGE WAY, 3.5 WIDE (DP107878)
- (C) EASEMENT FOR SERVICES, 3.5 WIDE (DP107878)
- (D) RIGHT OF CARRIAGEWAY VARIABLE WIDTH
- (E) EASEMENT FOR OVERHANG 0.15 WIDE

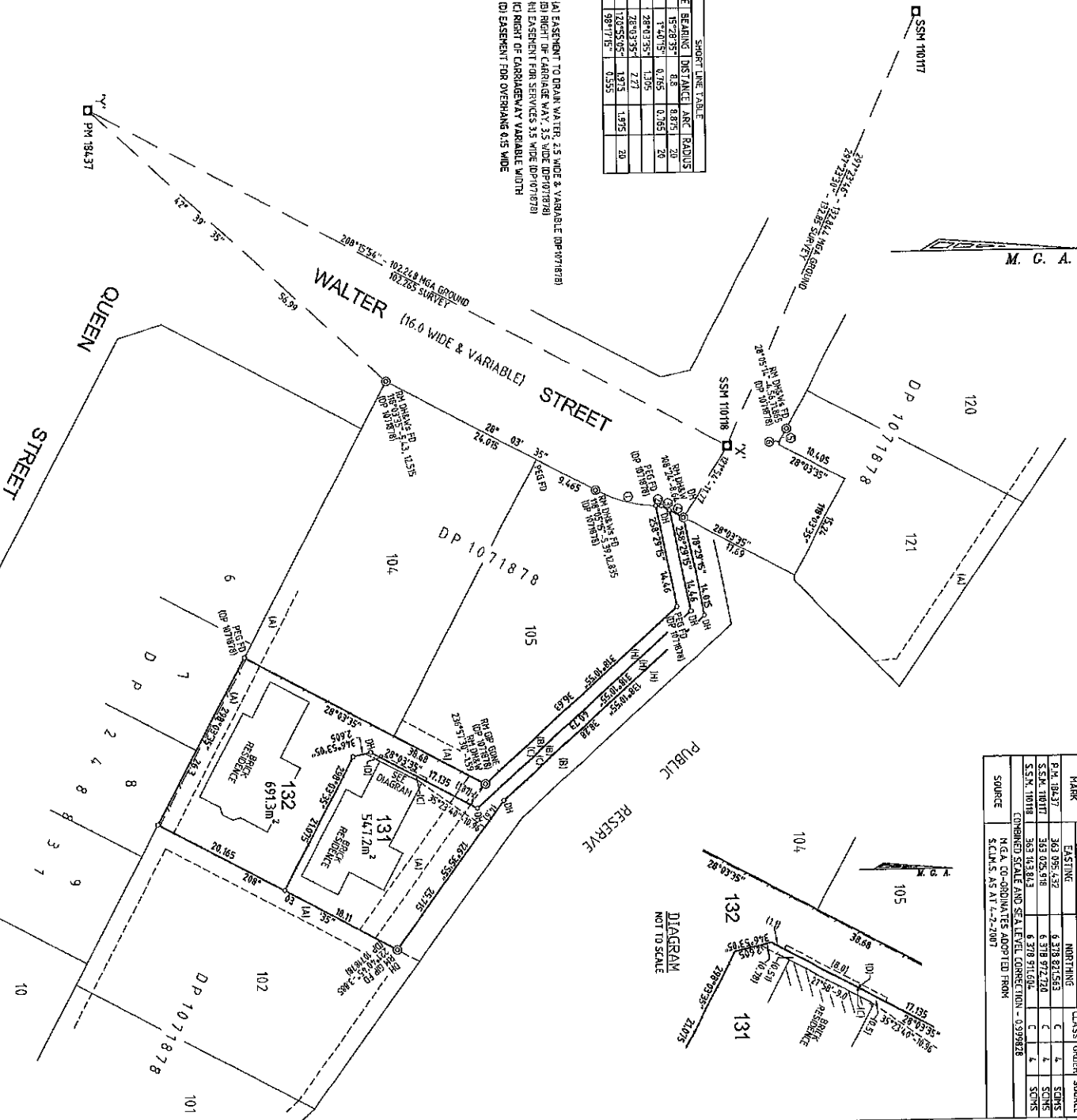

MARK	N.G.A. CO-ORDINATES - ZONE 56	EASTING	NORTHING	CLASS	ORDER	SOURCE
P.M. 18437	363 095.432	6 318 821.563	C	1	SCANS	
S.S.M. 10011	363 095.918	6 318 972.720	C	1	SCANS	
S.S.M. 10018	363 143.863	6 318 911.604	C	1	SCANS	

COMBINED SCALE AND SEAL LEVEL CORRECTION - 0.399828

N.G.A. CO-ORDINATES ADAPTED FROM S.C.M.S. AS AT 4-7-2007

Crown Lands Office Approval

Plan Approved: _____

Local District: _____

Project No: _____

Plan No: _____

Subdivision Certificate

I certify that provisions of a 100% of the Subdivision Planning and Assessment Act 1979 have been complied with in relation to the proposed:

SUBDIVISION

(Insert Subdivision or Plan No.)

SEE SIGNATURES FORM

Authorised Person/General Manager / Assistant General Manager

MAITLAND CITY COUNCIL

Date of endorsement: **2 APRIL 2007**

Acquisition no: _____

Subdivision Certificate no: **063117**

File no: **DA 06-3117**

Note: This plan is to be lodged electronically to the Land Title Office. The original plan must be submitted to the Registrar General.

* Dates indicate a hospital.

SAMPORES REFERENCE: **395.06**

10 20 30 40 50 60 70 80 90 100 110 120 130 140 150 160 170 180 190 200 210 220 230 240 250 260 270 280 290 300 310 320 330 340 350 360 370 380 390

WARNING: CREASING OR FOLDING WILL LEAD TO REJECTION

REGISTRATION INFORMATION

Registered: **12.12.2007**

SEE CERTIFICATE

The System: **TORRENS**

Purpose: **SUBDIVISION**

Reference: **U4572-24 #**

Lot Plan: **DP1071878**

PLAN OF SUBDIVISION OF LOT 103 DP 1071878

Lengths are in metres. Reduction Ratio: 1:400

Lot: **MAITLAND**

Suburb/Localities: **RUTHERFORD**

Parish: **MAITLAND**

County: **NORTHUMBERLAND**

This is sheet 1 of my plan (to be inserted if applicable)

VOIETTA KANEVA

of STRINE DONLEN, PUBLICIST MAITLAND NSW 2323

a surveyor registered under the Survey Act 2002. I hereby certify that the survey represented in this plan in accordance with the provisions of the Survey Act 2002 was completed on **17th FEBRUARY 2007** and the survey complies with **LOTS 131 & 132**

(These sheets are not colour surveyed or surveyed by any method shown in the plan that is not the subject of the survey)

Signature: _____

Print Name: **VOIETTA KANEVA**

Profession: **Surveyor**

Registration No: **2002**

Zone: **Urban / Metro**

Plans used in preparation of survey/compilation: **DP 1071878**

PANEL FOR USE ONLY for statements of intention to dedicate public roads, to create public reserves, drainage reserves, easements, restrictions on the use of land or positive covenants.

PURSUANT TO SECTION 888 OF THE CONVEYANCING ACT, 1919, AS AMENDED, IT IS INTENDED TO CREATE-

- 1. RIGHT OF CARRIAGEWAY VARIABLE WIDTH (C)
- 2. EASEMENT FOR OVERHANG 0.15 WIDE (D)

CERTIFICATES, SIGNATURES AND SEALS

Sheet 1 of 1 sheet(s)

PLAN OF SUBDIVISION OF LOT103 DP 1071878

DP1120704

Registered:  12.12.2007

Surveying Regulation, 2006

SIGNATURES, SEALS and STATEMENTS of intention to dedicate public roads or to create public reserves and drainage reserves.

VIOLETTA KANEVA

I, VIOLETTA KANEVA
 of RENNIE GOLLEDGE, P.O. BOX 132 MAITLAND 2320
 a surveyor registered under the Surveying Act, 2002, certify that the survey represented in this plan is accurate, has been made in accordance with the Surveying Regulation, 2006 and was completed



on: 9 FEBRUARY 2007

This survey relates to LOTS 131 & 132

(specify the land actually surveyed or specify any land shown in the plan that is not the subject of the survey)

Signature:  Dated 23-2-2007
 Surveyor registered under the Surveying Act, 2002

Datum Line: 'X'-'Y'
 Type: Urban /Rural

AUSTRALIA AND NEW ZEALAND
 BANKING GROUP LIMITED
 A.C.N. 005 357 522
 BY ITS ATTORNEY UNDER POWER
 OF ATTORNEY BOOK No. 446 No. 246

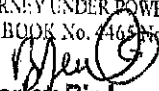
Beverley Bird
 ACTING MANAGER SECURITIES

JEFF REYES
 MORTGAGES DOCUMENTATION &
 SETTLEMENT NSW/ACT
 LEVEL 16, 1 MARKET ST, SYDNEY

Crown Lands NSW/Western Lands Office Approval

I,in approving this plan certify
 (Authorised Officer)
 that all necessary approvals in regard to the allocation of the land shown herein have been given

Signature:
 Date:
 File Number:
 Office:

Subdivision Certificate

I certify that provisions of s.109J of the Environmental Planning and Assessment Act 1979 have been satisfied in relation to:

the proposed SUBDIVISION set out herein
 (insert 'subdivision' or 'new road')

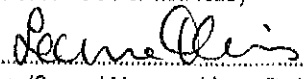
 * Authorised Person/General Manager / Accredited Certifier

Council Authority: MAITLAND CITY COUNCIL
 Date of endorsement: 2nd April 2007
 Accreditation no:
 Subdivision Certificate no: 063117
 File no: DA 06-3117

* Delete whichever is inapplicable.

SURVEYORS REFERENCE: 395.06

* OFFICE USE ONLY

ePlan

Instrument setting out Terms of Easements intended to be created or released, and of Profits a` Prendre, Restrictions on the Use of Land and Positive Covenants intended to be created pursuant to Section 88B of the Conveyancing Act, 1919.

(Sheet 1 of 2)

Plan: DP1120704

Plan of subdivision of Lot 103 in Deposited Plan 1071878
 Subdivision Certificate No. 063117

Full name and address of the owner of the land:

Tanya Pozdeev
 PO Box M123
 MONASH PARK NSW 2111

George Victor Pozdeev
 Unit 3/30-34 Romsey Street
 WAITARA NSW 2077

Part 1

Number of item shown in the intention panel of the plan	Identity of easement, profit a prendre, restriction or positive covenant referred to in the plan	Burdened lot(s) or parcels	Benefited lot(s), road(s), bodies or Prescribed Authorities
1	Right of Carriage Way variable width (C)	131 132	132 131
2	Easement for Overhang 0.15 wide (D)	132	131

Signed in my presence by Tanya Pozdeev being a proprietor of the land and who is personally known to me)

 Tanya Pozdeev

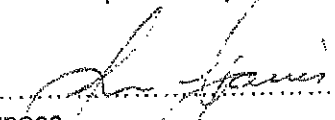
 Witness

Signed in my presence by George Victor Pozdeev being a proprietor of the land and who is personally known to me)

 George Victor Pozdeev

 Witness

SECTION 88B INSTRUMENT

Instrument setting out Terms of Easements intended to be created or released, and
of Profits a Prendre, Restrictions on the Use of Land and Positive Covenants
intended to be created pursuant to Section 88B of the Conveyancing Act, 1919.

(Sheet 2 of 2)

Plan: **DP1120704**

Plan of subdivision of Lot 103 in Deposited
Plan 1071878
Subdivision Certificate No. 063117

Mortgagee Under Mortgage No. AB911240

Signed at **SYDNEY**)
this **1ST** day, **NOVEMBER** 2007)
on behalf of Australia and New Zealand)
Banking Group Limited by it's duly)
appointed attorney:)

CLIFF REYES

MORTGAGES DOCUMENTATION &
SETTLEMENT NSW/ACT
LEVEL 18, 1 MARKET ST, SYDNEY
Witness

AUSTRALIA AND NEW ZEALAND
BANKING GROUP LIMITED
A.C.N. 005 357 522
BY ITS ATTORNEY UNDER POWER
OF ATTORNEY BOOK No. 445 No. 246

Beverley Bird

ACTING MANAGER SECURITIES

Australia and New Zealand Banking
Group Limited



PLAN FORM 2 (Approved Form 3)

SIGNATURES AND SEALS ONLY

Reviewed by Hillmount Holdings Pty.
 Universal Acid 015 res 506 by
 SOLE DIRECTOR/Secretary
 SOLE DIRECTOR/Secretary

Reviewed by John Alan Macfarlane Public by his
 Agent William Under Power of
 Attorney Registered Book 42285 No 97
 of Volume 10 of the Register of
 Instruments of the State of New South
 Wales DP 1044298 & DP 1048102
 Hillmount Holdings Pty. Ltd.
 SOLE DIRECTOR/Secretary

Department of Lands Approval
 In supporting this plan only
 The following conditions apply to the plan
 as shown on this plan only.
 Signature: _____
 Date: _____
 File Number: _____
 Office: _____

Subdivision Certificate
 I certify that the provisions of s.108 of the Environmental Planning
 and Assessment Act 1979 have been satisfied in relation to the
 proposed:
 Subdivision Certificate no. **DP 1044298**
 Date of endorsement: **16/01/04**
 Current Authority: **Metropolitan Local Council**
 Authorisation no.: _____
 Subdivision Certificate no. **DP 1044298**
 File no.: **DA 99-17074**

Department of Lands Approval
 In supporting this plan only
 The following conditions apply to the plan
 as shown on this plan only.
 Signature: _____
 Date: _____
 File Number: _____
 Office: _____

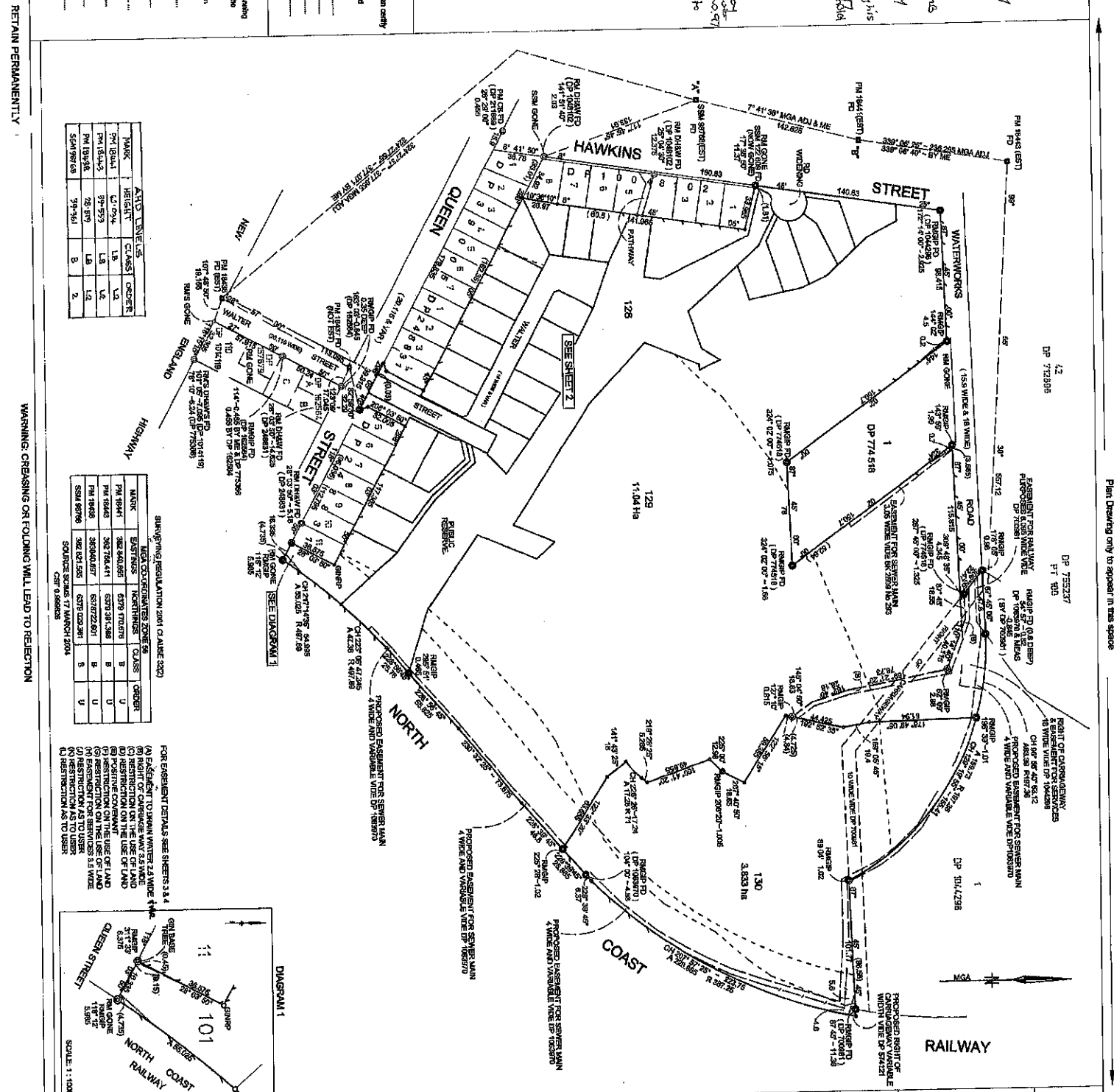

Plan Drawing only to appear in this space

DP1071878

Registered: 11/11/2004

Title System: TORRENS
 Purpose: SUBDIVISION

Ref map: U457224
 Last Plan: DP1044298, DP1048102

PLAN OF SUBDIVISION OF LOTS 2 & 3
 DP 1044298 AND LOT 9 DP 1048102

Local: RUTHERFORD
 Parish: MAITLAND
 County: NORTHUMBERLAND

Lengths in meters
 LGA: MAITLAND
 Parish: RUTHERFORD
 County: NORTHUMBERLAND

Surveying Information:
 Surveyed by: ROBERT CHARLES GIBBERN
 Date of Survey: 19/01/04
 Method: THEODOLITE

Scale: 1:1000
 Datum: MGA
 Projection: UTM

Notes:
 1) EASEMENT TO DRAIN WATER 2.5 M WIDE
 2) RIGHT OF CHANGING WIDE 2.5 M WIDE
 3) RESTRICTION ON THE USE OF LAND
 4) RESTRICTION ON THE USE OF LAND
 5) RESTRICTION ON THE USE OF LAND
 6) RESTRICTION ON THE USE OF LAND
 7) RESTRICTION ON THE USE OF LAND
 8) RESTRICTION ON THE USE OF LAND
 9) RESTRICTION ON THE USE OF LAND
 10) RESTRICTION ON THE USE OF LAND
 11) RESTRICTION ON THE USE OF LAND
 12) RESTRICTION ON THE USE OF LAND

FOR EASEMENT DETAILS SEE SHEETS 3 & 4
 (A) EASEMENT TO DRAIN WATER 2.5 M WIDE
 (B) RIGHT OF CHANGING WIDE 2.5 M WIDE
 (C) RESTRICTION ON THE USE OF LAND
 (D) RESTRICTION ON THE USE OF LAND
 (E) RESTRICTION ON THE USE OF LAND
 (F) RESTRICTION ON THE USE OF LAND
 (G) RESTRICTION ON THE USE OF LAND
 (H) RESTRICTION ON THE USE OF LAND
 (I) RESTRICTION ON THE USE OF LAND
 (J) RESTRICTION ON THE USE OF LAND

THE INTENTION IS TO PERPETUATE THE EXTENSION OF
 THE RAILWAY STREET AND THE EXTENSION OF HAWKINS
 STREET SHOWN ON DRAWING LOT 128 TO THE PUBLIC
 AS PUBLIC RESERVE

DIAGRAM 1
 SCALE: 1:1000

WARNING: CREASING OR FOLDING WILL LEAD TO REFLECTION

Department of Lands Approval
 In supporting this plan only
 The following conditions apply to the plan
 as shown on this plan only.
 Signature: _____
 Date: _____
 File Number: _____
 Office: _____

To be used in conjunction with Plan Form 2

WARNING: CREASING OR FOLDING

WILL LEAD TO REJECTION

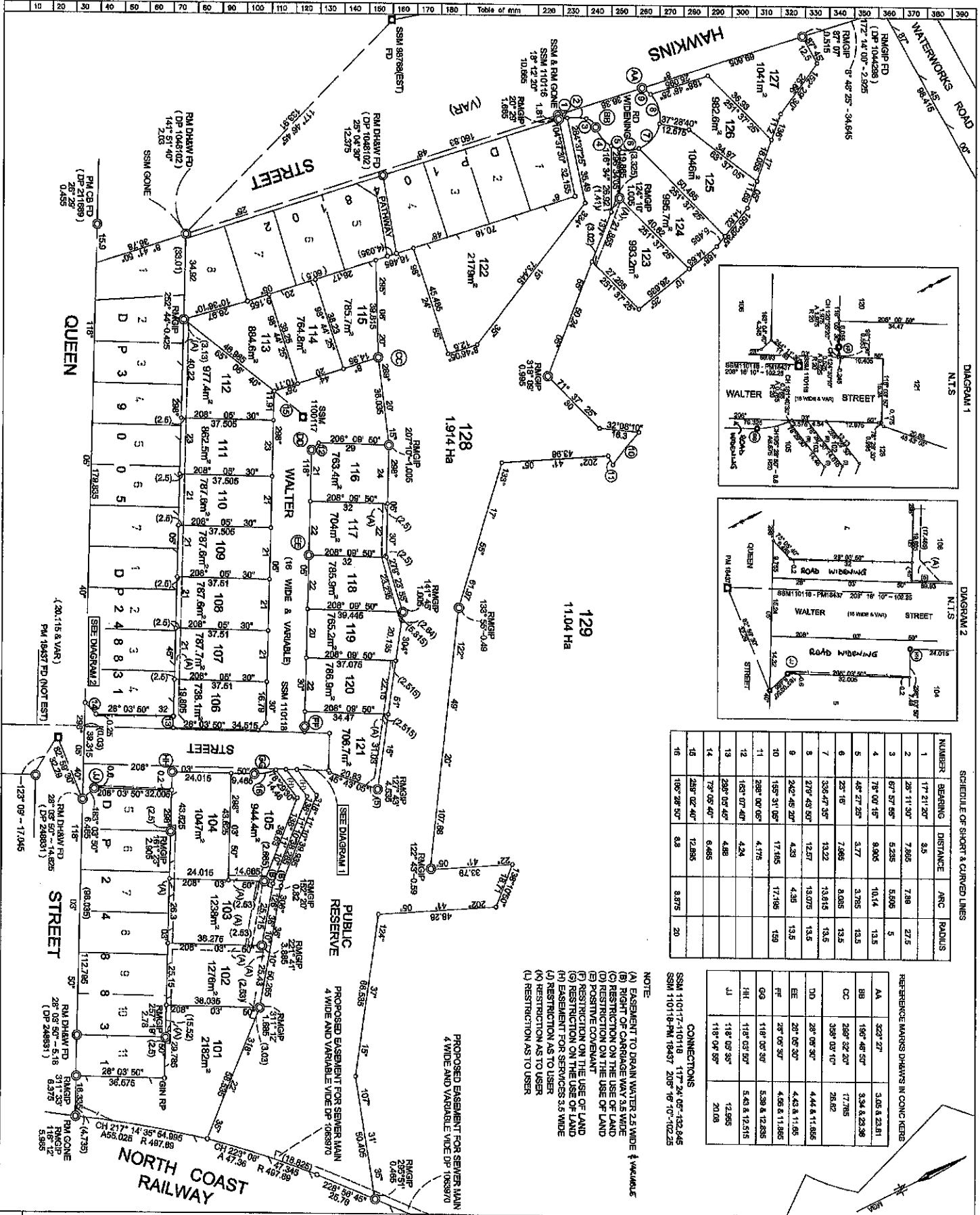

SCHEDULE OF SHORT & CURVED LINES

NUMBER	BEARING	DISTANCE	ARC	RADIUS
1	17° 21' 20"	3.5	7.88	27.5
2	28° 11' 30"	7.66	7.88	27.5
3	67° 57' 59"	5.28	5.06	5
4	78° 00' 15"	9.06	10.14	13.5
5	48° 27' 25"	3.77	3.78	13.5
6	25° 18'	7.86	8.08	13.5
7	336° 47' 35"	13.22	13.81	13.5
8	27° 43' 30"	12.57	13.07	13.5
9	242° 48' 20"	4.33	4.35	13.5
10	155° 31' 05"	17.48	17.18	139
11	288° 00' 05"	4.17	4.24	
12	163° 07' 48"	4.24		
13	288° 00' 05"	4.88		
14	79° 08' 40"	6.65		
15	288° 00' 40"	12.88		
16	180° 28' 50"	3.8	3.75	20

REFERENCE MARKS DRAWN IN CONC. KERBS

AA	BB	CC	DD	EE	FF	GG	HH	JJ
320° 27'	190° 48' 50"	288° 32' 20"	28° 08' 30"	20° 08' 30"	118° 08' 50"	118° 08' 50"	118° 08' 50"	118° 08' 50"
3.05 & 23.81	3.34 & 23.38	17.78	4.44 & 11.85	4.43 & 11.85	5.39 & 12.85	5.43 & 12.51	12.95	20.08

NOTE:
 (A) EASEMENT TO DRAIN WATER 2.5 WIDE & VARIABLE
 (B) RIGHT OF CARRIAGE WAY 3.5 WIDE
 (C) RESTRICTION ON THE USE OF LAND
 (D) RESTRICTION ON THE USE OF LAND
 (E) RESTRICTION ON THE USE OF LAND
 (F) RESTRICTION ON THE USE OF LAND
 (G) EASEMENT FOR SERVICES 3.5 WIDE
 (H) RESTRICTION AS TO USER
 (I) RESTRICTION AS TO USER
 (J) RESTRICTION AS TO USER

Registered: **DP1071878** 11.11.2004

This is sheet 2 of 3 of the plan of 3 sheets filed by DP 1071878.

Scale: 1:1000

Author: [Signature]

Checked: [Signature]

Drawn: [Signature]

Production Date: 11/11/2004

Production No: 1000

REGISTRAR GENERAL'S OFFICE

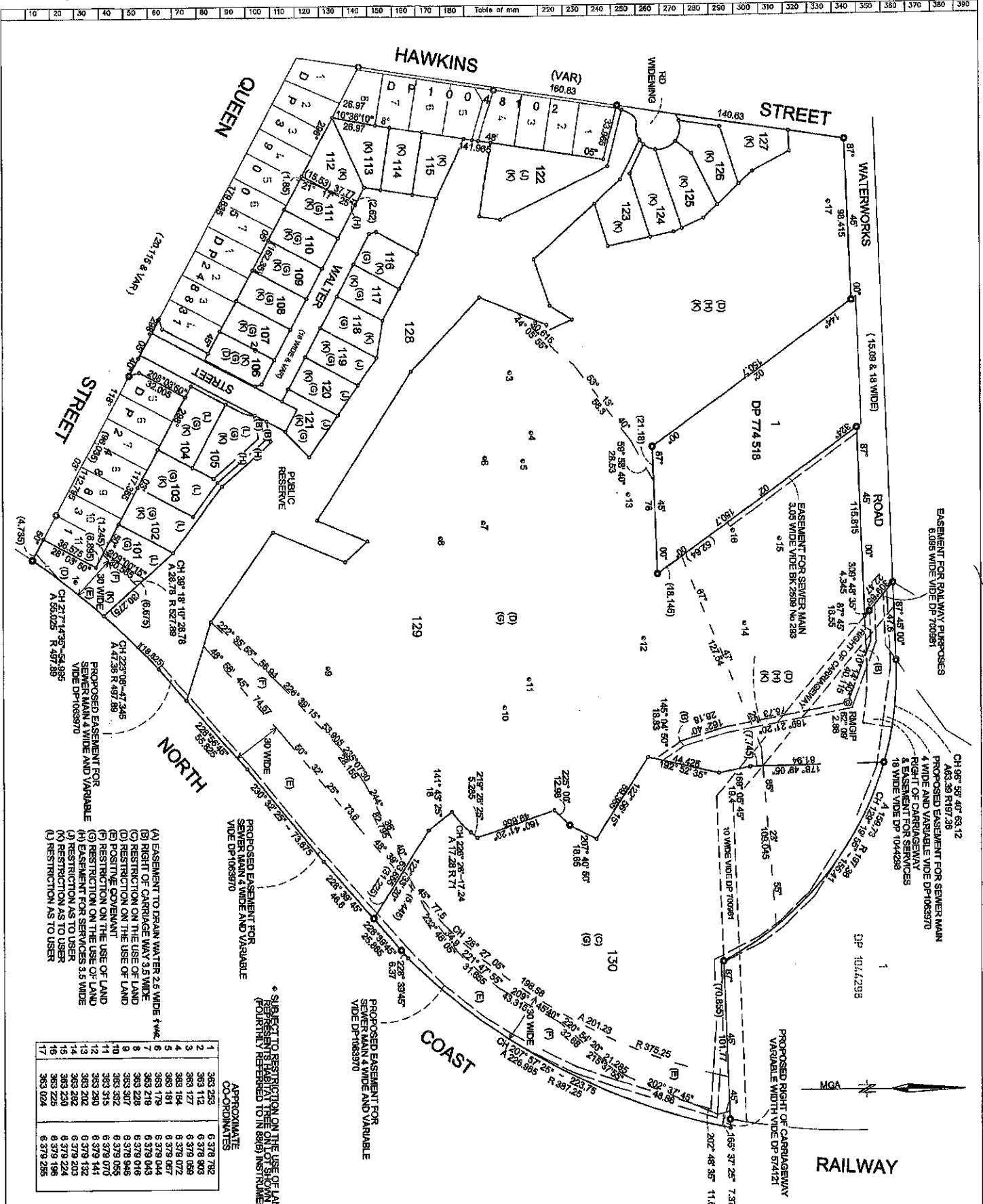

- (A) EASEMENT TO DRAIN WATER 2.5 WIDE
- (B) RIGHT OF CARRIAGE WAY 3.5 WIDE
- (C) RESTRICTION ON THE USE OF LAND
- (D) RESTRICTION ON THE USE OF LAND
- (E) POSITIVE COVENANT
- (F) RESTRICTION ON THE USE OF LAND
- (G) EASEMENT FOR SERVICES 3.5 WIDE
- (H) RESTRICTION AS TO USER
- (I) RESTRICTION AS TO USER
- (J) RESTRICTION AS TO USER

APPROXIMATE CO-ORDINATES

1	363 253	6 378 792
2	363 112	6 378 903
3	363 177	6 379 039
4	363 184	6 379 072
5	363 181	6 379 067
6	363 179	6 378 945
7	363 218	6 378 016
8	363 228	6 378 946
9	363 307	6 379 055
10	363 352	6 379 070
11	363 315	6 379 141
12	363 280	6 379 152
13	363 282	6 378 203
14	363 280	6 378 226
15	363 225	6 378 186
16	363 225	6 378 255
17	363 024	6 378 255

* SUBJECT TO RESTRICTION ON THE USE OF LAND REFERRED TO IN THE INSTRUMENT (IF APPLICABLE)

Registered: **DP1071878** 11/11/2004

This is sheet 3 of 3 of plan n. 3 sheet 1459234

Survey registered under the Survey Act 2002

This is sheet 3 of the plan of 3 sheets created by subdivision certificate no. 0241704 of 6/10/04

For use when space is insufficient in any point on Plan Form 2

Reduction Ratio: 1:500

Surveyors Reference: 100814

**INSTRUMENT SETTING OUT TERMS OF EASEMENTS INTENDED TO BE
 CREATED OR RELEASED PURSUANT TO SECTION 88B OF THE
 CONVEYANCING ACT 1919.**

Sheet 1 of 9

DP1071878

Plan of Subdivision of Lots 2 & 3 DP 1044298
 and Lot 9 DP1048102 covered by Subdivision
 Certificate No:

**FULL NAME AND ADDRESS
 OF THE OWNER OF THE
 LAND**

HILLHOLD PTY LIMITED
 ACN 099 129 441
 c/- PO BOX 40 MORPETH NSW 2321
 and
 HILLMOUNT HOLDINGS PTY LIMITED
 ACN 075 788 528
 c/- PO BOX 40 MORPETH NSW 2321
 JOHN ALAN MACBRIDE PRICE
 PO BOX 132, HAMILTON NSW 2303

**FULL NAME & ADDRESS OF
 MORTGAGEE :**

PART 1 (CREATION)

Number of item shown in the intention panel on the plan	Identity of easement, profit a prendre, restriction or positive covenant to be created and referred to in the plan	Burdened lot(s) or parcel(s):	Benefited lot(s), road(s), bodies or Prescribed Authorities:
1	Easement to Drain Water 2.5 wide & Variable	101 102 103 104 105 106 107 108 109 110 111	Lots 102 to 105 inclusive Lots 5 to 11 inclusive DP248831 101 Lots 103 to 105 inclusive Lots 5 to 11 inclusive DP248831 Lots 104 & 105 Lots 5 to 7 inclusive DP248831 Lots 5 & 6 DP248831 104 Lots 107 to 113 inclusive Lots 1 to 4 inclusive DP248831 Lots 2 to 7 inclusive DP39005 Lots 108 to 113 inclusive Lots 1 to 3 inclusive DP248831 Lots 2 to 7 inclusive DP39005 Lots 109 to 113 inclusive Lots 1 & 2 DP248831 Lots 2 to 7 inclusive DP39005 Lots 110 to 113 inclusive 1 DP248831 Lots 2 to 7 inclusive DP39005 Lots 111 to 113 inclusive Lots 2 to 7 inclusive DP39005 Lots 112 & 113 Lots 2 to 6 inclusive DP39005

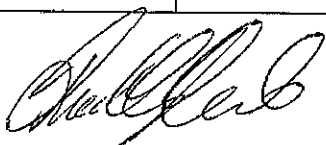

**INSTRUMENT SETTING OUT TERMS OF EASEMENTS INTENDED TO BE
 CREATED OR RELEASED PURSUANT TO SECTION 88B OF THE
 CONVEYANCING ACT 1919.**

Sheet 2 of 9

PART 1 (CREATION) cont'

DP1071878

Number of item shown in the intention panel on the plan	Identity of easement, profit a prendre, restriction or positive covenant to be created and referred to in the plan	Burdened lot(s) or parcel(s):	Benefited lot(s), road(s), bodies or Prescribed Authorities:
1 cont'	Easement to Drain Water 2.5 wide & Variable	112 117 118 119 120 121 123	113 Lots 2 to 4 inclusive DP39005 116 Lots 116 & 117 Lots 116 to 118 inclusive 119 Lots 119 & 120 124
2	Right of Carriage way 3.5 wide	102 103 129	103 102 130
3	Restriction on the Use of Land	130	Maitland City Council
4	Restriction on the Use of Land	101 106 129	Maitland City Council
5	Positive Covenant	101 Lots 129 & 130	Maitland City Council
6	Restriction on the Use of Land	101 Lots 129 & 130	Maitland City Council
7	Restriction on the Use of Land	Lots 101 to 112 inclusive Lots 116 to 121 inclusive Lots 129 & 130	Maitland City Council
8	Easement for Services 3.5 wide	102 103	103 102
9	Restriction as to User	Lots 119 to 122 inclusive	Lots 119 to 122 inclusive
10	Restriction as to User	Each of Lots 101 to 127 inclusive	Every other Lot
11	Restriction as to User	Lots 101 to 105 inclusive	Lots 101 to 105 inclusive



**INSTRUMENT SETTING OUT TERMS OF EASEMENTS INTENDED TO BE
CREATED OR RELEASED PURSUANT TO SECTION 88B OF THE
CONVEYANCING ACT 1919.**

DP1071878

PART 2 (TERMS)

Sheet 3 of 9

1. TERMS OF EASMENT TO DRAIN WATER 2.5 WIDE & VARIABLE

Terms set out in Part 3 Schedule 8 of the Act

2. TERMS OF RIGHT OF CARRIAGE WAY 3.5 WIDE

Terms set out in Part 1 Schedule 8 of the Act

3. TERMS OF RESTRICTION ON THE USE OF LAND

(a) No further subdivision shall occur on the subject lot until such time as Council receives written confirmation of the closure of the adjoining poultry operations or the incorporation of improved technology which reduces potential dust, odour and acoustic impacts.

(b) Any release, variation or modification of these restrictions shall be made and done in all respects at the cost and expense of the person or persons requesting same.

The party having the right to release, vary or modify these restrictions are the Maitland City Council.

4. TERMS OF RESTRICTION ON THE USE OF LAND

(a) No lopping, topping, removal, or destruction of the habitat trees which are identified on the above plan, shall occur unless supervised by an appropriately qualified person approved by Council.

(b) No development, including the erection of buildings or other works (including any changes in soil levels), excavation, trenching, filling or paving and the like, shall occur within a minimum distance of 5 metres as measured from the outer edge of the trunk of the habitat trees.

The party having the right to release, vary or modify these restrictions are the Maitland City Council

5. TERMS OF POSITIVE COVENANT

(a) The registered proprietor of the lots burdened by this covenant ("the proprietor" which expression where herein used shall be deemed to include the successors and assigns of the proprietor) pursuant to s.88E of the Conveyancing Act 1919 as amended that the proprietor shall be responsible for the ongoing maintenance of the



DP1071878

**INSTRUMENT SETTING OUT TERMS OF EASEMENTS INTENDED TO BE
CREATED OR RELEASED PURSUANT TO SECTION 88B OF THE
CONVEYANCING ACT 1919.**

Sheet 4 of 9

Landscape buffer 30 wide identified on the above plan to the satisfaction of the Manager Development Services of Maitland City Council.

6. TERMS OF RESTRICTION ON THE USE OF LAND

No dwelling shall be constructed on the lots burdened at a point where the noise level is greater than 80dB(A) as shown on the plan above and the Noise Assessment Report prepared by Sinclair Knight Merz dated 20 May 2002 (Queenst_Acousticreport_200502.Doc NE00593)

The party having the right to release, vary or modify this restriction is the Maitland City Council.

7. TERMS OF RESTRICTION ON THE USE OF LAND

(a) Dwellings experiencing external noise levels of greater than 65dB(A) shall have glazing on the facades facing the rail line of acoustic rating presented in the Table 4_1 of the Noise Assessment Report prepared by Sinclair Knight Merz dated 20 May 2002 (Queenst_Acousticreport_200502.Doc NE00593)

(b) The masonry construction of such dwellings shall have an acoustic rating of not less than Rw45. For these dwellings, 50mm thick acoustic insulation shall be installed in the roof space.

(c) A propriety test certificate or a letter of opinion from a recognised Acoustical Consultant shall be submitted to Council in conjunction with a development application for dwellings on the burdened lots to ensure compliance with the design criteria has been achieved.

(d) The provision for mechanical or natural ventilation for the identified noise affected dwellings shall be undertaken in conjunction with a development application for any proposed dwelling

The party having the right to release, vary or modify this restriction is the Maitland City Council.

8. TERMS OF EASEMENT FOR SERVICES 3.5 WIDE

Terms set out in Part ^{II} Schedule 8 of the Act



DP1071878

**INSTRUMENT SETTING OUT TERMS OF EASEMENTS INTENDED TO BE
CREATED OR RELEASED PURSUANT TO SECTION 88B OF THE
CONVEYANCING ACT 1919.**

Sheet 5 of 9

9. TERMS OF RESTRICTION AS TO USER

No habitable dwelling shall be erected, or shall be permitted to remain if the habitable floor levels are not constructed a minimum of 500mm above the 1% AEP flood storm level (at the time of construction) of the adjacent plain or watercourse.

This level is depicted on a drawing held by Maitland City Council entitled "Stage 1 – Open Swale work as executed survey and 1 in 100 year flood envelope" Revision D.

The party having the right to release, vary or modify this restriction is the Maitland City Council.

10. TERMS OF RESTRICTION AS TO USER

(a) No building or buildings shall be erected on each lot burdened other than with external walls of brick and/or brick veneer and/or stone and/or concrete and/or glass and/or timber and/or fibre cement provided that the proportion of brick and/or brick veneer and/or stone and/or concrete and/or glass shall not be less than 75% of the total area of the external walls

(b) No main building shall be erected or be permitted to remain erected on each lot burdened having a total floor area less than 150 square metres, including car accommodation, covered landings and patios.

(c) No more than one main dwelling shall be erected on each lot burdened and such dwelling shall not be used or be permitted to be used other than for residential purposes PROVIDED THAT more than one main building may be erected with the prior written consent of Hillhold Pty Limited and Hillmount Holdings Pty Limited, which consent may be given by such companies or refused in their absolute discretion.

(d) No building shall be erected or allowed to remain on any lot burdened by these Restrictions on the Use of Land unless such building has a roof comprised of concrete tiles, clay tiles or a non-reflective metal (i.e. Colorbond or equivalent).

(e) No ancillary building erected on any lot burdened shall have a roof of any material other than that of the main building unless the pitch of the roof of the ancillary building is less than 10 degrees to the horizontal and the roof of the ancillary building is not visible from the road frontage of each lot burdened.

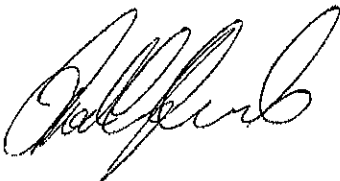

DP1071878

**INSTRUMENT SETTING OUT TERMS OF EASEMENTS INTENDED TO BE
CREATED OR RELEASED PURSUANT TO SECTION 88B OF THE
CONVEYANCING ACT 1919.**

Sheet 6 of 9

(f) No buildings, including any car accommodation or other outside structure on any lot burdened, shall be erected unless finished in a good and workmanlike manner in accordance with the best practices of the relevant trade using only first quality materials.

(g) No building which has previously been erected on other land shall be erected or placed on any lot burdened.

(h) No fence shall be erected on any lot burdened between the street alignment and the building line as fixed by the responsible Council and what constitutes a fence shall be determined by Hillhold Pty Ltd and Hillmount Holdings Pty Ltd and its decision shall be final and binding on the registered proprietor of each lot burdened.

(i) No fence shall be erected on each lot burdened to divide it from any adjoining land owned by Hillhold Pty Limited and/or Hillmount Holdings Pty Limited without the consent of Hillhold Pty Limited and/or Hillmount Holdings Pty Limited but such consent shall not be withheld if such fence is erected without expense to Hillhold Pty Limited and/or Hillmount Holdings Pty Limited and is otherwise satisfactory to Hillhold Pty Limited and/or Hillmount Holdings Pty Limited, provided that this restriction shall remain in force only during such time as Hillhold Pty Limited and/or Hillmount Holdings Pty Limited are the registered proprietors of any adjoining land.

(j) No fence on any lot burdened shall

- (i) Extend past the front building alignment; or
- (ii) Be constructed otherwise than in accordance with local standards. For the purpose of this restriction, corner lots burdened shall be deemed to have frontages to two streets.

(k) No car accommodation on any lot burdened shall be provided unless such accommodation is to a minimum standard of a simple carport under the same roof as the main building or detached but in the same form of construction as the main building.

(l) No more than one driveway shall access any lot burdened. No driveway may be wider than 5.5 metres at the street boundary of any lot burdened.

(m) No lot burdened shall, at any time during construction of a main building or other building, be kept untidy with building debris and/or waste. No debris and/or waste is to be temporarily stored on a site during construction unless it is stored within a suitably sized industrial bin or skip or at the rear of the main building and within the lot burdened.



DP1071878

**INSTRUMENT SETTING OUT TERMS OF EASEMENTS INTENDED TO BE
CREATED OR RELEASED PURSUANT TO SECTION 88B OF THE
CONVEYANCING ACT 1919.**

Sheet 7 of 9

(n) No lot burdened shall be kept otherwise than in a clean neat and tidy condition at all times. No rubbish shall be allowed to accumulate or be placed upon any lot burdened and no incinerator or other article connected with the disposal or storage of rubbish (except for domestic rubbish bins) shall be used.

(o) No trees on any lot burdened may be excessively pruned, injured or removed from the lot other than for the purpose of construction of a building on such lot. If a tree is excessively pruned, injured or removed, a replacement tree of similar size and establishment is to be planted elsewhere on the lot.

(p) No temporary dwelling, caravan, privy, advertising sign or hoarding or anything which shall be an eyesore shall be brought onto or erected on any lot burdened except sheds, workshops or office rooms to be used for the purpose of and only in connection with the building of permanent buildings in the course of constructions upon the lot burdened. In no instance shall any structure be used as a temporary dwelling on any lot burdened.

(q) No sign or advertisement of any nature whatsoever shall be placed or erected on any lot burdened with the exception of the display of a builder's sign no larger than 1 metre x 1 metre or one sign indicating the lot is for sale. No such sign shall be erected unless it is in keeping with the overall estate signage. This restriction expires on 1 January, 2005.

(r) At no time shall another lot be disturbed or used for access or storage by the registered proprietor or occupier of any lot burdened or by any person on their behalf.

(s) No commercial or heavy transport vehicles may be parked on a regular or permanent basis (other than in connection with the construction of a building) on any lot burdened or in the street.

(t) No further subdivisions shall be effected in respect of each lot burdened without the prior written consent of Hillhold Pty Limited and Hillmount Holdings Pty Limited, which consent may be given by such companies or refused in their absolute discretion.

The parties having the right to release, vary or modify these restrictions are Hillhold Pty Limited and Hillmount Holdings Pty Limited.



DP1071878

**INSTRUMENT SETTING OUT TERMS OF EASEMENTS INTENDED TO BE
CREATED OR RELEASED PURSUANT TO SECTION 88B OF THE
CONVEYANCING ACT 1919.**

Sheet 8 of 9

11. TERMS OF RESTRICTION AS TO USER

No habitable dwelling shall be erected, or shall be permitted to remain if the habitable floor level is not constructed above the level 13.3m AHD.

The party having the right to release, vary or modify this restriction is the Maitland City Council.

A handwritten signature in black ink, appearing to be 'Phillip B', is located at the bottom left of the page.

DP1071878

**INSTRUMENT SETTING OUT TERMS OF EASEMENTS INTENDED TO BE
CREATED OR RELEASED PURSUANT TO SECTION 88B OF THE
CONVEYANCING ACT 1919.**

Sheet 9 of 9

Executed by

~~THE COMMON SEAL of~~ HILLHOLD

PTY LIMITED ACN 099 129 441 was

hereto affixed by authority of its

Directors in the presence of: by:

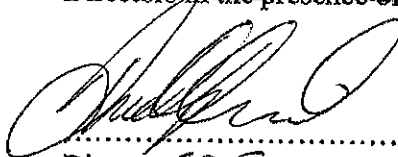

.....
Director SOLE DIRECTOR / Authorised Officer
SECRETARY

PAUL GRAHAM UNICOM

Print Name

Print Name

Executed by

~~THE COMMON SEAL of~~ HILLMOUNT

HOLDINGS PTY LIMITED ACN 075 788 528

was hereto affixed by authority of its

Directors in the presence of: by

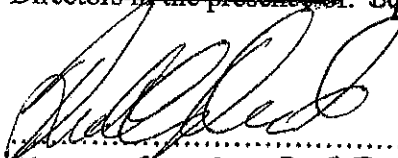

.....
Director SOLE DIRECTOR / Authorised Officer
SECRETARY

MATTIAMS CITY COUNCIL

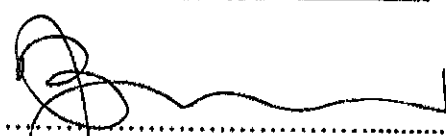

PAUL GRAHAM UNICOM

Print Name

BRAD EVERETT

Print Name M C C

Signed by John Alan MacBride Price by his
Attorney William West under Power of
Attorney Registered Book 4288 NO. 97
in respect of Hillhold Pty. Limited
Mortgage no. 8510566

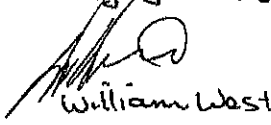
William West

Signed by John Alan MacBride Price
by his Attorney William West under Power
of Attorney Registered Book 4288 NO. 97
in respect of Hillmount Holdings Pty. Ltd.
Mortgage no. 9038391

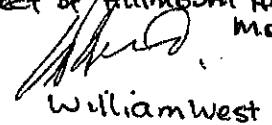
William West

Witness

Trevor Thomas Laycock
Solicitor 31-33 Watt St
Newcastle

Witness

Trevor Thomas Laycock
Solicitor 31-33 Watt St
Newcastle.

REGISTERED 8 11.11.2004

Certificate No.: PC/2021/2225

Certificate Date: 14/07/2021

Fee Paid: \$53.00

Receipt No.: 1046010

Your Reference: 2021/3028

SECTION 10.7 PLANNING CERTIFICATE
Environmental Planning and Assessment Act, 1979 as amended

APPLICANT:	Infotrack Property Services Pty Ltd ecertificates@infotrack.com.au
PROPERTY DESCRIPTION:	2/9A Walter Street RUTHERFORD NSW 2320
PARCEL NUMBER:	44973
LEGAL DESCRIPTION:	Lot 131 DP 1120704

IMPORTANT: Please read this Certificate carefully.

This Certificate contains important information about the land described above.

Please check for any item, which could be inconsistent with the proposed use or development of the land. If there is anything you do not understand, please contact Council by phoning (02) 4934 9700, or personally at Council's Administration Building at 285-287 High Street, Maitland.

The information provided in this Certificate relates only to the land described above. If you require information about adjoining or nearby land, or about the Council's development policies or codes for the general area, contact Council's Planning & Environment Department.

All information provided is correct as at the date of issue of this Certificate, however it is possible for changes to occur at any time after the issue of this Certificate. We recommend that you only rely upon a very recent Certificate.

The following responses are based on the Council's records and/or information from sources outside the Council. The responses are provided with all due care and in good faith, however the Council cannot accept responsibility for any omission or inaccuracy arising from information outside the control of the Council.

Furthermore, while this Certificate indicates the general effect of the zoning of the abovementioned land, it is suggested that the applicable planning instruments be further investigated to determine any additional requirements.

Copies of Maitland City Council's Local Environmental Planning Instrument, Development Control Plans and Policies are available from Council's [website](#).

PART 1: MATTERS PROVIDED PURSUANT TO SECTION 10.7 (2)

1. Local Environmental Plan (LEP)

Maitland LEP 2011, published 16 December 2011, applies to the land.

Exhibited draft Local Environmental Plans

No draft local Environmental Plans that have been on public exhibition under the Act are applicable to the land.

Development Control Plan prepared by Council

Maitland Development Control Plan 2011 applies to the land.

Development Control Plan prepared by the Director General

The Council has not been notified of any Development Control Plan applying to the land that has been prepared by the Director-General under section 51A of the Act.

State Environmental Planning Policies

The Minister for Planning has notified that the following State Environmental Planning Policies (SEPPs) shall be specified on Certificates under Section 10.7 of the Environmental Planning and Assessment Act, 1979.

The land is affected by the following State Environmental Planning Policies:

- SEPP21 Caravan Parks
- SEPP (Mining, Petroleum Production and Extractive Industries) 2007
- SEPP (State and Regional Development) 2011
- SEPP33 Hazardous and Offensive Development
- SEPP36 Manufactured Home Estates
- SEPP (Koala Habitat Protection) 2019
- SEPP50 Canal Estate Development
- SEPP (Housing for Seniors or People with a Disability) 2004
- SEPP55 Remediation of Land
- SEPP Affordable Rental Housing 2009
- SEPP Building Sustainability Index: BASIX 2004
- SEPP (Exempt and Complying Development Codes) 2008
- SEPP (Infrastructure) 2007
- SEPP64 Advertising and Signage
- SEPP Primary Production and Rural Development 2019
- SEPP65 Design Quality of Residential Apartment Development
- SEPP70 Affordable Housing (Revised Schemes)
- SEPP (Concurrences and Consents) 2018
- SEPP Vegetation in Non Rural Areas 2017
- SEPP (Educational Establishments and Child Care Facilities) 2017

Draft State Environmental Planning Policies

The following draft State Environmental Planning Policy(s) applying to the land is, or has been, the subject of community consultation or on public exhibition under the Act:

Housekeeping Amendment to the State Environmental Planning Policy (Exempt and Complying Development Codes) 2008

The proposed amendments to this SEPP are housekeeping amendment to the Codes SEPP to simplify and improve the policy, clarify definitions and standards, and address other minor technical matters raised. The proposed housekeeping amendment to the Codes SEPP will simplify and improve the policy, clarify definitions and standards, and address other minor technical matters.

2. Zoning and land use under relevant LEPs

Maitland LEP 2011, published 16 December 2011, identifies the zone applying to the land as:

R1 General Residential

The following development information gives the objectives of the zone, the description of the zone and identifies development allowed or prohibited in each zone. Development consent where required, must be obtained from the Council.

R1 General Residential

a) Purpose/Objective

- To provide for the housing needs of the community
- To provide for a variety of housing types and densities
- To enable other land uses that provide facilities or services to meet the day to day needs of residents

b) Permitted with Consent

Attached dwellings; Bed and breakfast accommodation; Boarding houses; Building identification signs; Business identification signs; Centre-based child care facilities; Community facilities; Dwelling houses; Group homes; Home-based child care; Home industries; Hostels; Hotel or motel accommodation; Multi dwelling housing; Neighbourhood shops; Oyster aquaculture; Places of public worship; Pond-based aquaculture; Residential flat buildings; Respite day care centres; Roads; Semi-detached dwellings; Seniors housing; Serviced apartments; Shop top housing; Tank-based aquaculture; Any other development not specified in item 2 or 4

c) Permitted without Consent

Home occupations

d) Prohibited

Agriculture; Air transport facilities; Airstrips; Amusement centres; Animal boarding or training establishments; Biosolids treatment facilities; Boat building and repair facilities; Boat launching ramps; Boat sheds; Camping grounds; Car parks;

Caravan parks; Cemeteries; Charter and tourism boating facilities; Commercial premises; Correctional centres; Crematoria; Depots; Eco-tourist facilities; Entertainment facilities; Extractive industries; Farm buildings; Forestry; Freight transport facilities; Function centres; Heavy industrial storage establishments; Helipads; Highway service centres; Home occupations (sex services); Industrial retail outlets; Industrial training facilities; Industries; Information and education facilities; Jetties; Marinas; Mooring pens; Moorings; Mortuaries; Open cut mining; Passenger transport facilities; Public administration buildings; Recreation facilities (indoor); Recreation facilities (major); Registered clubs; Research stations; Restricted premises; Rural industries; Rural workers' dwellings; Service stations; Sewage treatment plants; Sex services premises; Signage; Storage premises; Tourist and visitor accommodation; Transport depots; Truck depots; Vehicle body repair workshops; Vehicle repair stations; Veterinary hospitals; Warehouse or distribution centres; Waste or resource management facilities; Water recreation structures; Water recycling facilities; Wharf or boating facilities; Wholesale supplies.

e) Land dimensions to permit the erection of a dwelling house on the land

For the land zoned R1 General Residential the Maitland LEP 2011 does not contain a development standard specifying the land dimensions required to permit the erection of a dwelling house on the land.

f) Critical Habitat

No Local Environmental Plan or draft Local Environmental Plan identifies the land as including or comprising critical habitat.

g) Conservation Area

The land IS NOT in a Heritage Conservation Area.

h) Item of Environmental Heritage

The land does NOT contain an item of Environmental Heritage.

3. Complying Development

Complying development under the **Housing Code** may be carried out on the land.

Complying development under the **Low Rise Medium Density Housing Code** may be carried out on the land. Complying development under the **Greenfield Housing Code** may be carried out on the land, but only if the land is identified on the *Greenfield Housing Code Area Map* issued by the NSW Department of Planning and Environment.

Complying development under the **Rural Housing Code** may not be carried out on the land as it is not within an applicable zone.

Complying development under the **Housing Alterations Code** may be carried out on the land.

Complying development under the **General Development Code** may be carried out on the land.

Complying development under the **Commercial and Industrial Alterations Code** may be carried out on the land.

Complying development under the **Commercial and Industrial (New Buildings**

and Additions) Code may not be carried out on the land as it is not within an applicable zone.

Complying development under the **Subdivisions Code** may be carried out on the land.

Complying development under the **Demolition Code** may be carried out on the land.

Complying development under the **Fire Safety Code** may be carried out on the land.

Complying development under the **Container Recycling Facilities Code** may not be carried out on the land.

Note: Despite the above provisions, if only part of a lot is subject to an exclusion or exemption under Clause 1.17A or Clause 1.19 of State Environmental Planning Policy (Exempt and Complying Development Codes) Amendment (Commercial and Industrial Development and Other Matters) 2013, complying development may be carried out on that part of the lot that is not affected by the exclusion or exemption.

4B. Annual charges under Local Government Act 1993 for coastal protection services that relate to existing coastal protection works

The owner (or any previous owner) of the land has NOT consented in writing to the land being subject to annual charges under section 496B of the Local Government Act 1993 for coastal protection services that relate to existing coastal protection works (within the meaning of section 553B of that Act).

5. Coal Mine Subsidence Compensation Act 2017

The land has NOT been proclaimed to be within a Mine Subsidence District under the meaning of section 20 of the Coal Mine Subsidence Compensation Act 2017.

6. Road widening and road realignment

- a) The land is NOT affected by road widening under Division 2 of Part 3 of the Roads Act 1993.
- b) The land is NOT affected by any environmental planning instrument
- c) The land is NOT affected by any road-widening or realignment under any resolution of the Council

The information above relates to Council's road proposals only. Other authorities, including Roads and Maritime Services, may have proposals, which have not been set out.

7. Council and other public authority policies on hazard risk restrictions

All land within the Maitland Local Government Area has the potential to contain acid sulfate soils. Clause 7.1 of the Maitland Local Environmental Plan 2011 generally applies. Development consent is required where works described in the Table to this clause are proposed on land shown on the Maitland LEP 2011 Acid Sulfate Soils Map as being of the class specified for those works.

The Council has adopted a Contaminated Lands Policy to provide a framework to appropriately manage land contamination risk through the land use planning process. This Policy seeks to ensure that changes in land use will not increase the risk to human health or the environment. The Policy applies to all land in the

Maitland Local Government Area.

7A. Flood Related Development Controls

Development on this land or part of this land for the purposes of dwelling houses, attached dwellings, dual occupancies, multi dwelling housing or residential flat buildings (not including development for the purposes of group homes or seniors housing) is NOT subject to flood related development controls contained within clause 7.3 of the Maitland LEP 2011 and s.B3 of the Maitland DCP 2011.

Development on this land or part of this land for any other purpose is NOT subject to flood related development controls contained within clause 7.3 of the Maitland LEP 2011 and s.B3 of the Maitland DCP 2011.

Information given in relation to flooding is based upon Council's adopted 1:100 ARI (Average Recurrent Interval) flood event.

The Maitland LEP 2011 identifies the flood planning level (FPL) as the level of a 1:100 ARI flood event plus 0.5m freeboard.

8. Land Reserved for Acquisition

No environmental planning instrument, deemed environmental planning instrument or draft environmental planning instrument applying to the land provides for the acquisition of the land by a public authority, as referred to in section 3.15 of the Act.

9. Contribution Plans

The following contribution plan(s) apply to the land:

- Maitland S94A Levy Contributions Plan 2006
- Maitland City Wide Section 94 Contributions Plan 2016
- Maitland S94 Contributions Plan (City Wide) 2006

Contributions Plans may be viewed on Council's website or inspected and purchased at Council's Customer Service Centre.

9A. Biodiversity Certified Land

The land is not biodiversity certified land under Part 8 of the Biodiversity Conservation Act 2016.

10. Biodiversity Stewardship Sites

The Council is not aware if the land is a biodiversity stewardship site under a biodiversity stewardship agreement under part 5 of the *Biodiversity Conservation Act 2016*.

10A. Native Vegetation clearing set asides

The Council is not aware if the land contains a set aside area under 60ZC of the *Local Land Services Act 2013*.

11. Bushfire Prone Land

The land is NOT identified as being bushfire prone land.

12. Property vegetation plans

The Council has not received any notification from Hunter Local Land Services that this land is affected by a property vegetation plan under Part 4 of the Native Vegetation Act 2003 (and that continues in force).

13. Order under Trees (Disputes between Neighbours) Act 2006

Council has NOT received notification from the Land and Environment Court of NSW that the land is affected by an Order under Trees – (Disputes Between Neighbours) Act 2006.

14. Directions under Part 3A

There is NO direction by the Minister under Section 75P(2)(c1) of the Act that a provision of an environmental planning instrument prohibiting or restricting the carrying out of a project or a stage of a project on the land under Part 4 (other than a project of a class prescribed by the regulations) of the Act does not have effect.

15. Site Compatibility Certificate and Conditions for Seniors Housing

a) Site Compatibility Certificate

Council is unaware of whether a current Site Compatibility Certificate issued under Clause 25 of the State Environmental Planning Policy (Housing for Seniors and People with a Disability) 2004 has been issued for the land.

b) Conditions of Development Consent since 11 October 2007

No development consent has been granted for the development permitted under State Environmental Planning Policy (Housing for Seniors and People with a Disability) 2004 after 11 October 2007.

16. Site compatibility certificates for infrastructure, schools or TAFE establishments

Council is unaware of whether a valid Site Compatibility Certificate has been issued under clause 19 of State Environmental Planning Policy (Infrastructure) 2007 for the land.

17. Site compatibility certificates and conditions for affordable rental housing

Council is unaware if a Site Compatibility Certificate (Affordable Rental Housing) has been issued in accordance with State Environmental Planning Policy (Affordable Rental Housing) 2009.

18. Paper subdivision information

There is no development plan that applies to the:

- 1) Land or that is proposed to be subject to a consent ballot
- 2) There is no subdivision order that applies to the land.

19. Site verification certificates

Council is not aware of any current site verification certificate in respect of the land.

20. Loose-fill asbestos insulation

There are no premises on the subject land listed on the register.

21. Affected building notices and building product rectification orders

The Council is NOT aware of any affected building notice which is in force in respect

of the land.

The Council is NOT aware of any building product rectification order which is in force in respect of the land and that has not been fully complied with.

The Council is NOT aware of any notice of intention to make a building product rectification order being given in respect of the land and that is outstanding.

Note. The following matters are prescribed by section 59(2) of the Contaminated Land Management Act 1997 as additional matters to be specified in a planning certificate.

Contaminated Land

- a) The land to which this certificate relates is NOT significantly contaminated land within the meaning of the Contaminated Land Management Act 1997.
 - b) The land to which this certificate relates is NOT subject to a management order within the meaning of the Contaminated Land Management Act 1997.
 - c) The land to which this certificate relates is NOT the subject of an approved voluntary management proposal within the meaning of the Contaminated Land Management Act 1997.
 - d) The land to which this certificate relates is NOT the subject to an ongoing maintenance order within the meaning of the Contaminated Land Management Act 1997.
 - e) Council has NOT been provided with a site audit statement, within the meaning of the Contaminated Land Management Act 1997, for the land to which this Certificate relates.
-

David Evans
General Manager



HUNTER WATER CORPORATION

A.B.N. 46 228 513 446

SERVICE LOCATION PLAN

Enquiries: 1300 657 657

APPLICANT'S DETAILS



InfoTrack

9A WALTER

RUTHERFORD NSW

APPLICATION NO.: 1446499

APPLICANT REF: M 2021/3028

RATEABLE PREMISE NO.: 0829020281

PROPERTY ADDRESS: 2/9A WALTER ST RUTHERFORD 2320

LOT/SECTION/DP:SP: 131//DP 1120704

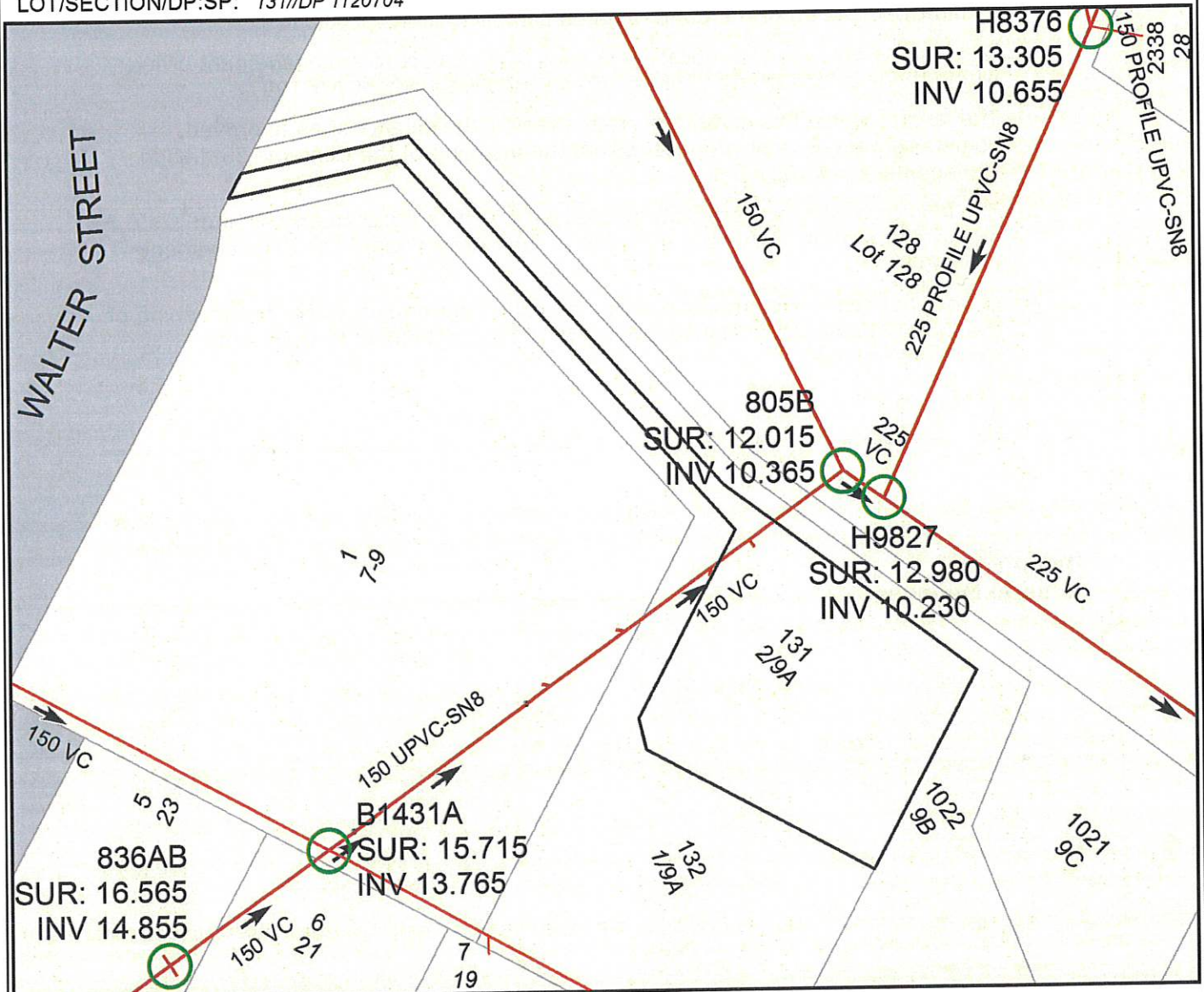

SEWER POSITION APPROXIMATE ONLY.
SUBJECT PROPERTY BOLDED.
ALL MEASUREMENTS ARE METRIC.

IF A SEWERMAIN IS LAID WITHIN THE BOUNDARIES OF THE LOT, SPECIAL REQUIREMENTS FOR THE PROTECTION OF THE SEWERMAIN APPLY IF DEVELOPMENT IS UNDERTAKEN. IN THESE CASES, IT IS RECOMMENDED THAT YOU SEEK ADVICE ON THE SPECIAL REQUIREMENTS PRIOR TO PURCHASE. PHONE 1300 657 657, FOR MORE INFORMATION.

IMPORTANT:
IF THIS PLAN INDICATES A SEWER CONNECTION IS AVAILABLE OR PROPOSED FOR THE SUBJECT PROPERTY, IT IS THE INTENDING OWNERS RESPONSIBILITY TO DETERMINE WHETHER IT IS PRACTICABLE TO DISCHARGE WASTEWATER FROM ALL PARTS OF THE PROPERTY TO THAT CONNECTION.

ANY INFORMATION ON THIS PLAN MAY NOT BE UP TO DATE AND THE CORPORATION ACCEPTS NO RESPONSIBILITY FOR ITS ACCURACY.

Date: 12/07/2021

Scale at A4: 1:500

CADASTRAL DATA © LPI OF NSW
CONTOUR DATA © AAMHatch
© Department of Planning

SEWER/WATER/RECYCLED WATER
UTILITY DATA
© HUNTER WATER CORPORATION